

rolled lift-off hinges with pin $\varnothing 5\text{mm}$
stainless steel 304/A2/1.4301
both leaves swaged, knuckle $\varnothing 8\text{mm}$
rounded tips out of stainless steel 304/A2
with 6 countersunk screwholes (3,5mm/M4)

h	x	w	x	t	pin	stand	boxes
50	x	40	x	1,5 mm	5mm	LH	20 Pcs
50	x	40	x	1,5 mm	5mm	RH	20 Pcs

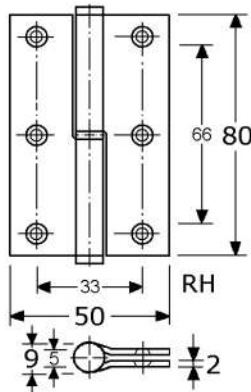

rolled lift-off hinges with pin $\varnothing 5\text{mm}$
stainless steel 304/A2/1.4301 satin polished
both leaves swaged, knuckle $\varnothing 9\text{mm}$
flat tips & washer out of stainless steel 304/A2
with 6 countersunk screwholes (4mm/M4)

h	x	w	x	t	pin	stand	boxes
80	x	50	x	2	mm	LH	20 Pcs
80	x	50	x	2	mm	RH	20 Pcs

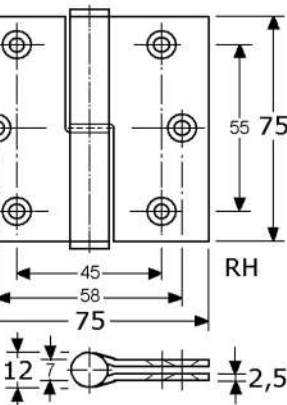

rolled lift-off hinges with pin SS-316/A4 $\varnothing 5\text{mm}$
stainless steel 316/A4/1.4401 satin polished
both leaves swaged, knuckle $\varnothing 9\text{mm}$
flat tips & washer out of stainless steel 316/A4
with 6 countersunk screwholes (4mm/M4)

h	x	w	x	t	pin	stand	boxes
80	x	50	x	2	mm	LH	20 Pcs
80	x	50	x	2	mm	RH	20 Pcs

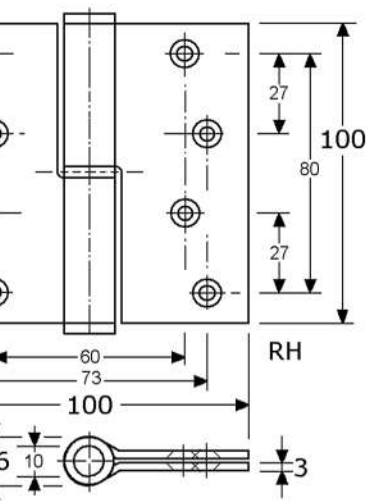

rolled lift-off hinges with pin $\varnothing 10\text{mm}$
stainless steel 304/A2/1.4301 satin polished
both leaves swaged, knuckle $\varnothing 16\text{mm}$
flat tips & washer out of stainless steel 304/A2
with 8 countersunk screwholes (5mm/M5)

h	x	w	x	t	pin	stand	boxes
100x100x3	mm	10mm			LH	10 Pcs	
100x100x3	mm	10mm			RH	10 Pcs	

(also possible without holes, see page GY-340a)



PIMEX B.V.
Coenecoop 131
2741 PJ WADDINXVEEN (NL)
Tel. (31) 182 - 61 11 66
Email: info@pimex.nl

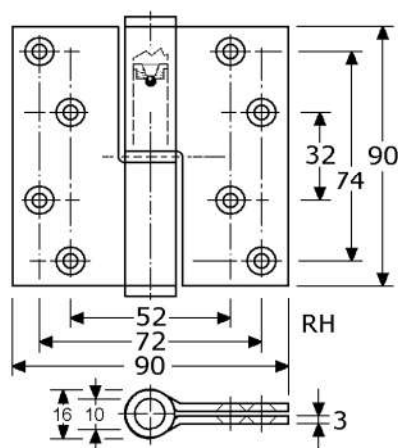

DIN Rs

335221
335222

rolled lift-off hinges with pin ø10mm
stainless steel 304/1.4301 satin polished
both leaves swaged for mortise application
pin & tips out of stainless steel 304/A2
top leaf rides on a ball bearing in the top of the pin
with stainless steel 304/A2 washer
with 8 countersunk screwholes (5mm/M5)
maximum door weight 45 Kg (2 hinges)

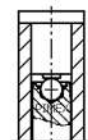

h	x	w	x	t	pin	stand	boxes
90	x	90	x	3 mm	10mm	LH	10 Pcs
90	x	90	x	3 mm	10mm	RH	10 Pcs

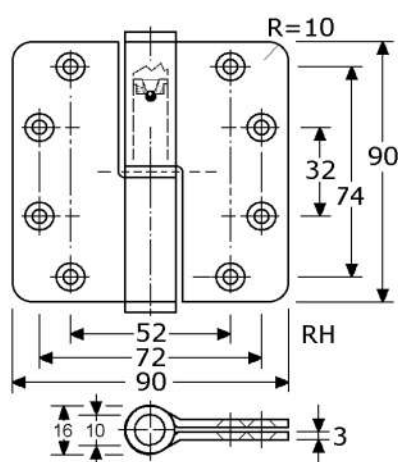

A4
316

335223
335224

rolled lift-off hinges with pin ø10mm
stainless steel 316/1.4401 satin polished
both leaves swaged for mortise application
pin & tips out of stainless steel 316/A4
top leaf rides on a ball bearing in the top of the pin
rounded, with stainless steel 316/1.4401/A4 washer
with 8 countersunk screwholes (5mm/M5)
maximum door weight 45 Kg (2 hinges)

A4
316



h	x	w	x	t	pin	stand	boxes
90	x	90	x	3 mm	10mm	LH	10 Pcs
90	x	90	x	3 mm	10mm	RH	10 Pcs



LH



RH

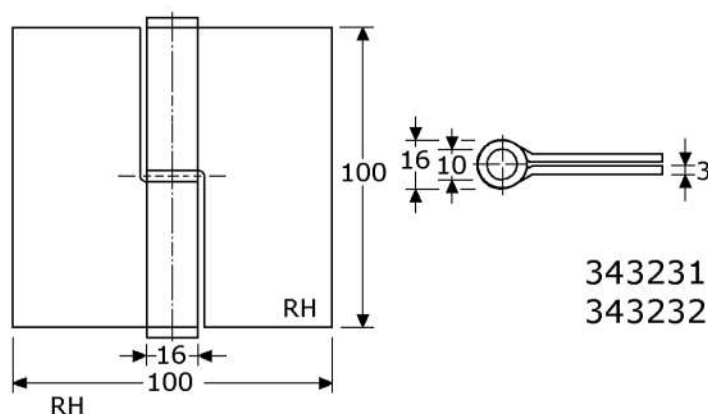

343231
343232

PIROSTA lift-off hinges
stainless steel 304/A2/1.4301 satin polished
both leaves swaged for mortise application
pin & tips out of stainless steel 304/A2
with stainless steel 304/A2 washer, no holes

h	x	w	x	t	pin	stand	boxes
100	x	100	x	3 mm	10mm	LH	10 Pcs
100	x	100	x	3 mm	10mm	RH	10 Pcs



RH

for wider hinges in stainless steel 316/A4
100x220x3mm, see page GY-341b



PIMEX B.V.
Coenecoop 131
2741 PJ WADDINXVEEN (NL)
Tel. (31) 182 - 61 11 66
Email: info@pimex.nl

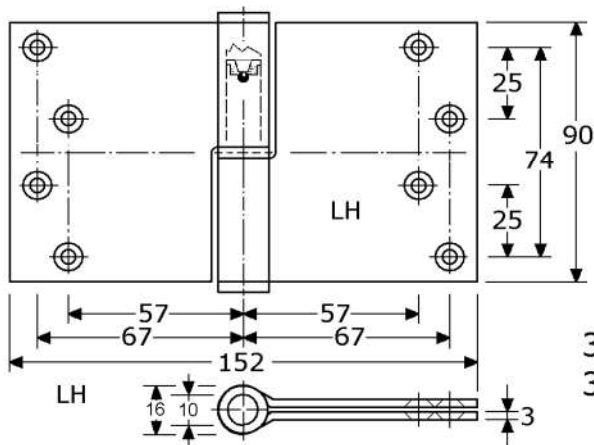

335241
335242

rolled lift-off hinges with pin $\varnothing 10\text{mm}$
stainless steel 304/1.4301 satin polished
both leaves swaged for mortise application
pin & tips out of stainless steel 304/A2
top leaf rides on a ball bearing in the top of the pin
with stainless steel 304/A2 washer
with 8 countersunk screwholes (5mm/M5)
maximum door weight 45 Kg (2 hinges)

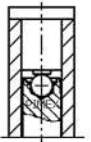

h	x	w	x	t	pin	stand	boxes
90	x	152	x	3 mm	10mm	LH	2 Pcs
90	x	152	x	3 mm	10mm	RH	500 Pcs



LH

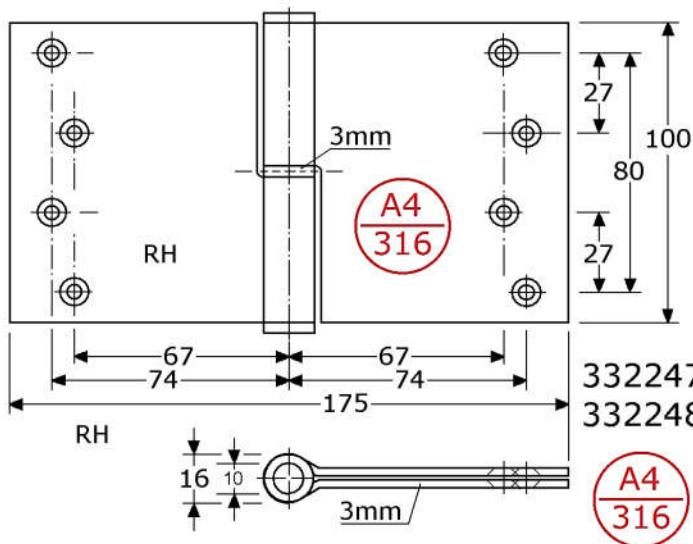

332247
332248

rolled lift-off hinges with pin $\varnothing 10\text{mm}$
stainless steel 316/1.4401 satin polished
both leaves swaged for mortise application
pin & tips out of stainless steel 316/A4
with stainless steel 316/A4 washer
with 8 countersunk screwholes (5mm/M5)

h	x	w	x	t	pin	stand	boxes
100	x	175	x	3 mm	10mm	LH	10 Pcs
100	x	175	x	3 mm	10mm	RH	10 Pcs



LH



RH

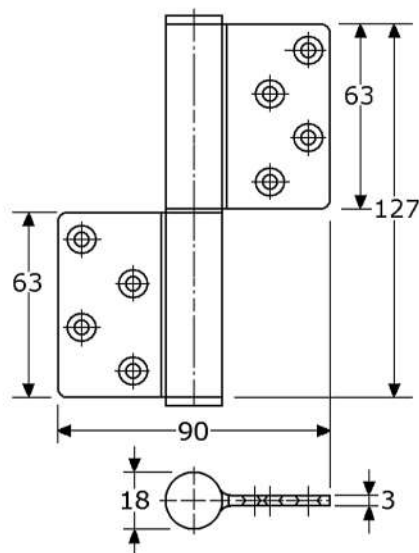

339273



lift-off flag hinges, LH/RH
stainless steel 304/A2 satin polished
rolled centre type, knuckle $\varnothing 18\text{mm}$
pin & flat tips out of stainless steel 304/A2
top leaf rides on a ball bearing in the top of the pin
with stainless steel 304/A2 washer $\varnothing 18\text{mm} \times 1\text{mm}$
with 4+4 screwholes from both sides countersunk
maximum door weight 50 Kg (2 hinges)

h	x	w	x	t	pin	stand	boxes
127	x	90	x	3 mm	12mm	LH/RH	8 Pcs

lift-off flag hinges without holes are normally stock,
see from page GY-343a



PIMEX B.V.
Coenecoop 131
2741 PJ WADDINXVEEN (NL)
Tel. (31) 182 - 61 11 66
Email: info@pimex.nl

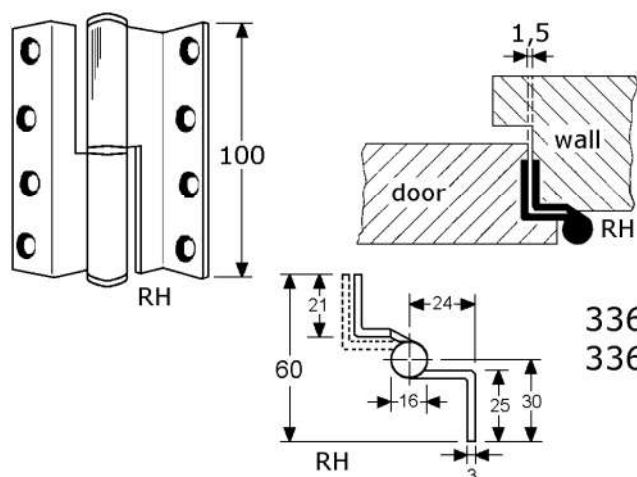

336231
336232

rolled lift-off hinges with pin $\varnothing 10\text{mm}$
stainless steel 304/A2/1.4301 satin polished
cranked 13mm for butt overlay doors
knuckle $\varnothing 16\text{mm}$, rectangular
flat tips & washer out of stainless steel 304/A2
with 8 countersunk screwholes (5mm/M5)

h	x	w	x	t	pin	stand	boxes
100x	60	x	3	mm	10mm	LH	500 Pcs
100x	60	x	3	mm	10mm	RH	10 Pcs

PIMEX has also lift-off hinges out of other materials:

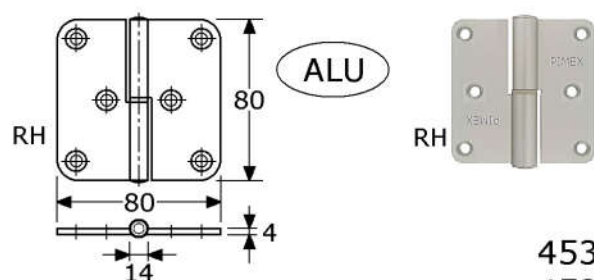

453521
453522

lift-off hinges with stainless steel pin $\varnothing 8\text{mm}$
leaves out of aluminium alloy
both leaves swaged, knuckle $\varnothing 14\text{mm}$
with white plastic bushing and white nylon ring
with 6 countersunk screwholes (5mm/M5)

h	x	w	x	t	pin	stand	boxes
80	x	80	x	4 mm	8mm	LH	25 Pcs
80	x	80	x	4 mm	8mm	RH	25 Pcs

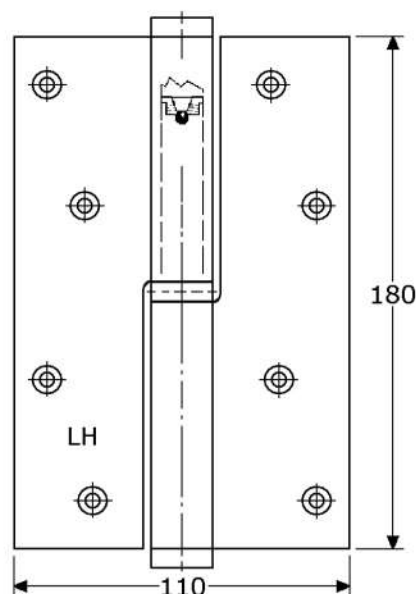

335291

rolled lift-off hinges with pin $\varnothing 10\text{mm}$
stainless steel 304/1.4301 satin polished
both leaves swaged for mortise application
pin & tips out of stainless steel 304/A2
top leaf rides on a ball bearing in the top of the pin
knuckle $\varnothing 22\text{mm}$, with washer stainless steel 304/A2
with 8 countersunk screwholes (5mm/M5)
maximum door weight 45 Kg (2 hinges)
(only these last 2 hinges possible)

h	x	w	x	t	pin	stand	boxes
180x	110	x	4	mm	14mm	LH	2 Pcs

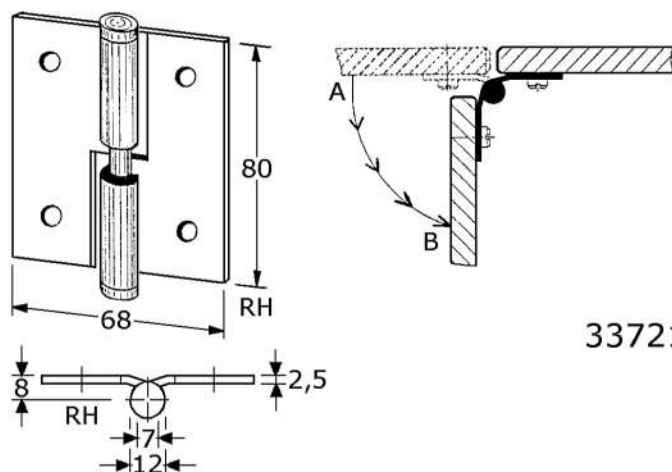
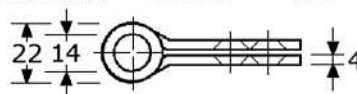

337212

falling lift-off hinges with pin $\varnothing 7\text{mm}$
stainless steel 304/A2/1.4301 satin polished
both leaves flat rolled for full surface application
door is falling from A to open-stand B ##
pin stainless steel 304/A2 $\varnothing 7\text{mm}$, knuckle $\varnothing 13\text{mm}$
flat tips & washer out of stainless steel
with 4 round holes $\varnothing 6,5\text{mm}$
(only these last 3 hinges possible)

h	x	w	x	t	pin	stand	boxes
80	x	68	x	2,5 mm	7mm	RH	3 Pcs



PIMEX B.V.
Coenecoop 131
2741 PJ WADDINXVEEN (NL)
Tel. (31) 182 - 61 11 66
Email: info@pimex.nl

A4
316

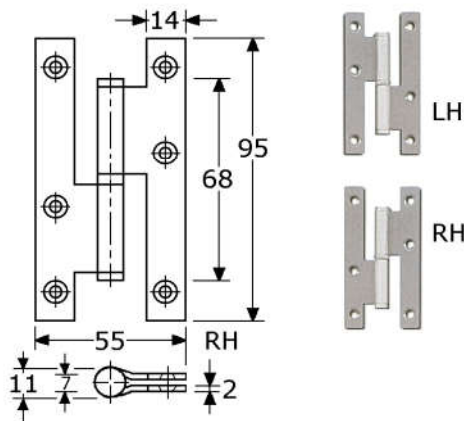

A4
316

333207
333208

rolled lift-off hinges with pin $\varnothing 7\text{mm}$
stainless steel 316/A4/1.4401 satin polished
both leaves swaged, knuckle $\varnothing 11\text{mm}$, rectangular
flat tips & washer out of stainless steel 316/A4
with 6 countersunk screwholes (3,5mm/M4)
delivery on request: minimum = 500 Pcs/stand

h x w x t	pin	stand	boxes
95 x 55 x 2 mm	7mm	LH	500/1000 Pcs
95 x 55 x 2 mm	7mm	RH	500/1000 Pcs

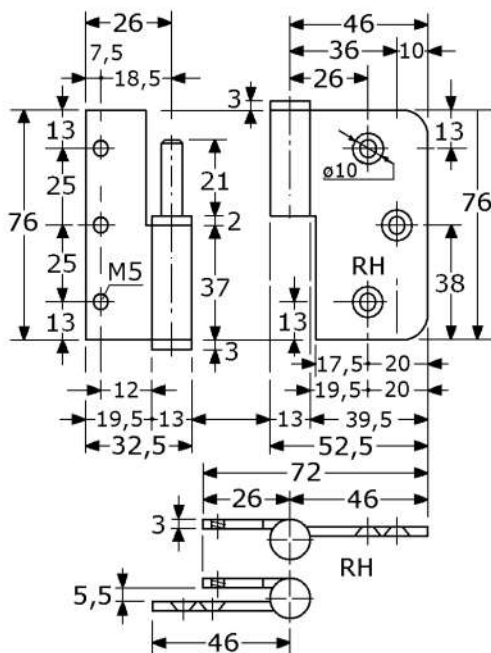

334275
334276

rolled lift-off hinges with pin $\varnothing 7\text{mm}$
stainless steel 304/A2/1.4301 satin polished
pin stainless steel 304/A2 $\varnothing 7\text{mm}$, knuckle $\varnothing 13\text{mm}$
flat tips & washer out of stainless steel
1 leaf flat rolled, 1 leaf swaged rolled
with 3 tapped holes M5 c.t.c. 50mm
with 3 countersunk screwholes
delivery on request: minimum = 500 Pcs/stand

h x w x t	pin	stand	boxes
76 x 72 x 3 mm	7mm	LH	500/1000 Pcs
76 x 72 x 3 mm	7mm	RH	500/1000 Pcs



LH

RH

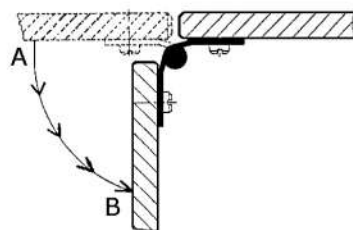
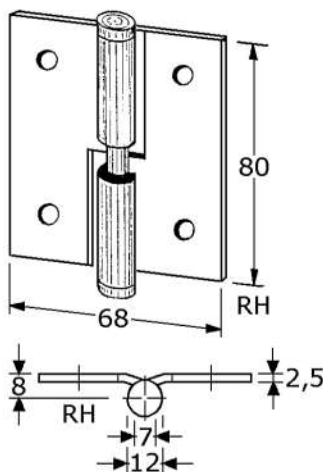

337212

falling lift-off hinges with pin $\varnothing 7\text{mm}$
stainless steel 304/A2/1.4301 satin polished
both leaves flat rolled for full surface application
door is falling from A to open-stand B ##
pin stainless steel 304/A2 $\varnothing 7\text{mm}$, knuckle $\varnothing 13\text{mm}$
flat tips & washer out of stainless steel
with 4 round holes $\varnothing 6,5\text{mm}$
(only these last 3 hinges possible)

h x w x t	pin	stand	boxes
80 x 68 x 2,5 mm	7mm	RH	3 Pcs



PIMEX B.V.
Coenecoop 131
2741 PJ WADDINXVEEN (NL)
Tel. (31) 182 - 61 11 66
Email: info@pimex.nl

LIFT-OFF RISING HINGES, stainless steel

complete stainless steel 316/A4/1.4401 satin polished
for TRESPA-plate from 10mm to 30mm
with small leaves, rectangular
for mounting is only 3,5mm space required
for inset doors
for full mortise doors (door and wall in line)
for surface mounting of the door (minimum 15mm flush overlaid)
automatical falling/selfclosing from 225° to 0°
maximum opening 225°, not for welding
rising 6mm (for 90°) or 12mm (for 180°)

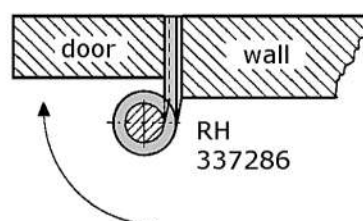
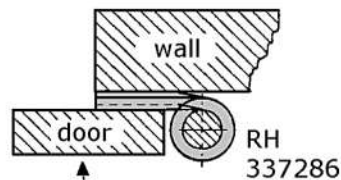
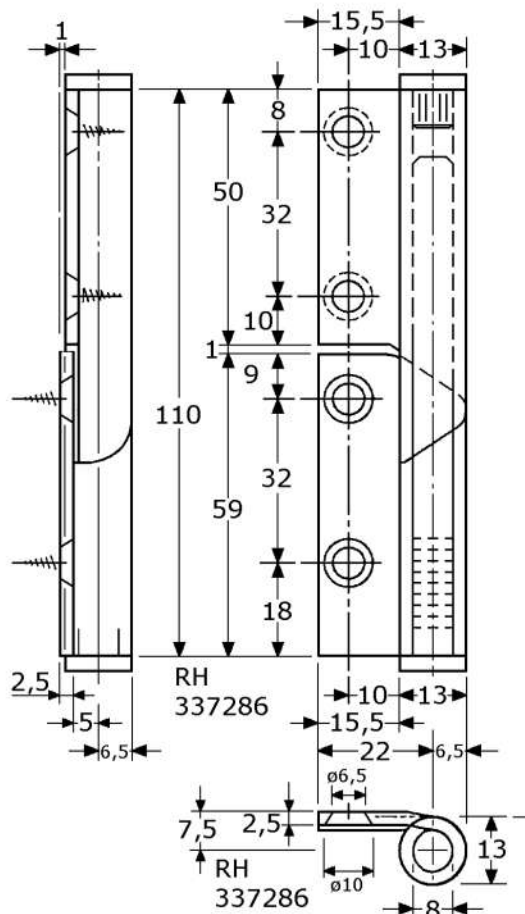

A4
316

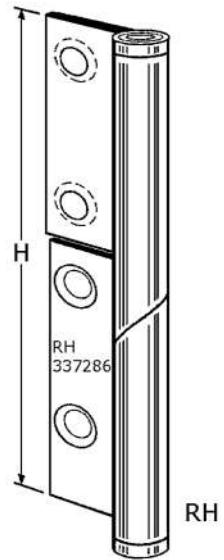

337285

PIROSTA hinge for plate 10-30mm, LH
stainless steel 316/A4/1.4401 satin polished
flat rolled, knuckle $\varnothing 13$ mm, small leaves
for full mortise doors or surface application
with pin stainless steel 316/A4 $\varnothing 8$ mm
automatical falling/selfclosing from 225° to 0°
flat tips stainless steel 316/A4
with 2+2 countersunked screwholes (5mm/M5)

h	x	w	x	t	pin	stand	boxes
110x	44	x	2,5	mm	8mm	DIN LH	10 Pcs

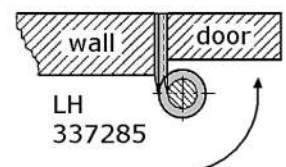
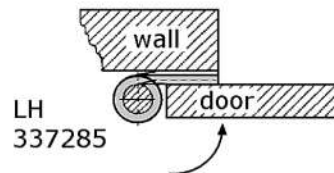

337286

PIROSTA hinge for plate 10-30mm, RH
stainless steel 316/A4/1.4401 satin polished
flat rolled, knuckle $\varnothing 13$ mm, small leaves
for full mortise doors or surface application
with pin stainless steel 316/A4 $\varnothing 8$ mm
automatical falling/selfclosing from 225° to 0°
flat tips stainless steel 316/A4
with 2+2 countersunked screwholes (5mm/M5)

h	x	w	x	t	pin	stand	boxes
110x	44	x	2,5	mm	8mm	DIN RH	10 Pcs

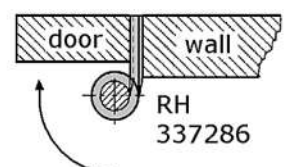
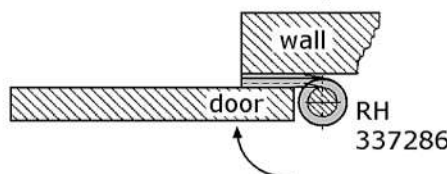

PIMEX B.V.
Coenecoop 131
2741 PJ WADDINXVEEN (NL)
Tel. (31) 182 - 61 11 66
Email: info@pimex.nl

LIFT-OFF RISING HINGES, stainless steel

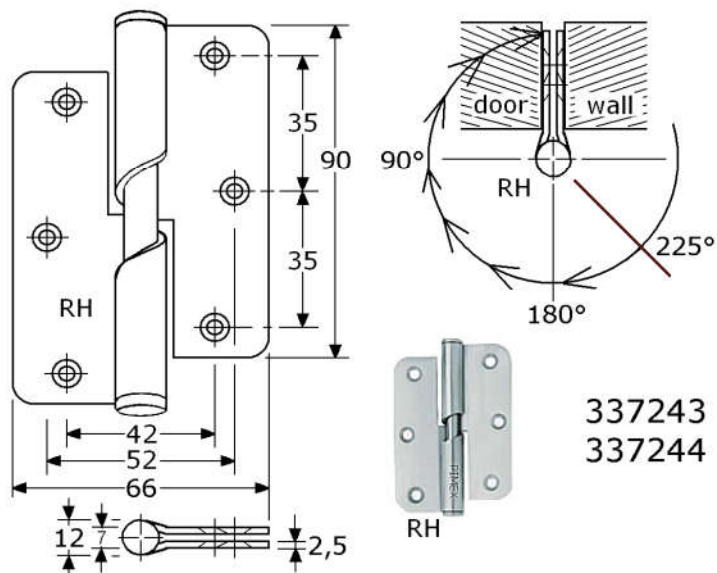

337243
337244

lift-off rising hinges, highness 90mm
stainless steel 304/A2/1.4301 satin polished
rolled leaves, knuckle $\varnothing 12\text{mm}$
both leaves swaged for full mortise doors
automatical falling/selfclosing from 225° to 0°
maximum opening hook $>270^\circ$
rising 7mm (for 180°) or 10mm (for 225°)
minimum door thickness 25mm
flat tips & washer out of stainless steel 304/A2
with 6 countersunk screwholes (4,5mm/M5)

h x w x t	pin	stand	boxes
90 x 66 x 2,5 mm	7mm	LH	10 Pcs
90 x 66 x 2,5 mm	7mm	RH	10 Pcs

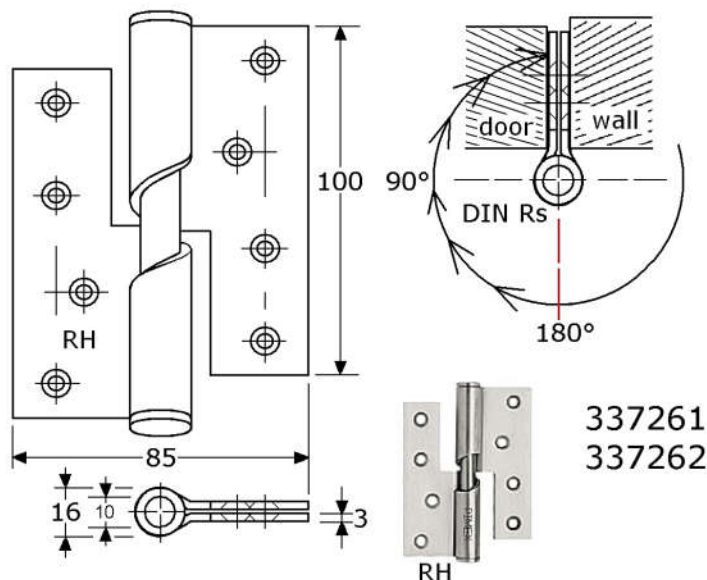

337261
337262

lift-off rising hinges, highness 100mm
stainless steel 304/A2/1.4301 satin polished
rolled leaves, knuckle $\varnothing 16\text{mm}$
both leaves swaged for full mortise doors
automatical falling/selfclosing from 180° to 0°
maximum opening hook $>270^\circ$
rising 12mm (for 180°)
minimum door thickness 35mm
flat tips & washer out of stainless steel 304/A2
with 8 countersunk screwholes (4,5mm/M5)

h x w x t	pin	stand	boxes
100x 85 x 3 mm	10mm	LH	10 Pcs
100x 85 x 3 mm	10mm	RH	10 Pcs

more possibilities:

hinges in stainless steel, spring loaded,
single or double,
see page GY-382



588234

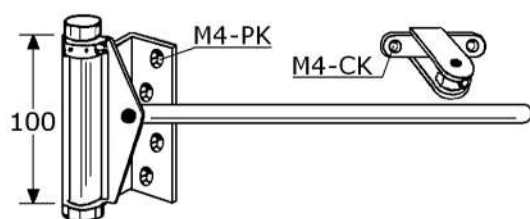

door closer, highness 100mm
stainless steel 304/A2/1.4301 satin polished
with stainless steel 304/A2 rod $\varnothing 8 \times 215\text{mm}$
with adjustable stainless steel spring
surface (after) mounting, easy installation
can be disconnected if necessary
with stainless steel rod guide with white nylon
in boxes of 6 Pcs.



PIMEX B.V.
Coenecoop 131
2741 PJ WADDINXVEEN (NL)
Tel. (31) 182 - 61 11 66
Email: info@pimex.nl

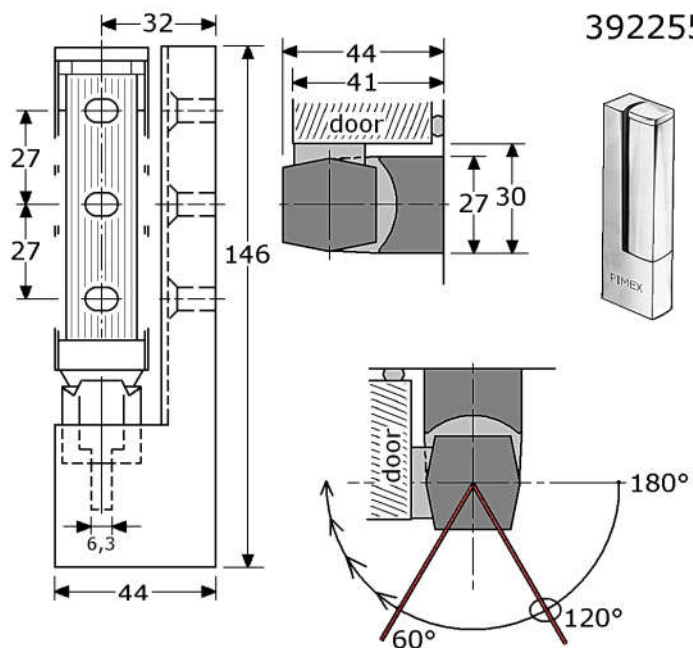

392255

heavy duty lift-off rising hinges, highness 146mm
stainless steel 304/A2/1.4301 satin polished
wall part:
solid casting, widthness 27mm, totally offset 44mm
with white nylon rising mechanism, rising 10mm
(simple mechanism rotation for LH/RH door)
with 3 countersunk screwholes (6mm/M6)
door part:
solid casting, with pin stainless steel 304 $\varnothing 6,3$ mm
with 3 adjustable screwholes (6mm/M6) with ribs
with loose rib plate stainless steel 304
with fixed stainless steel solid casting top
with profile cover stainless steel 304 satin polished

automatical falling/selfclosing from 60° to 0°
automatical holding at 120°
maximum opening hook 180°
for door thickness 41-60mm
in boxes of 2 Pcs.



392271

heavy duty lift-off rising hinges, highness 215mm
stainless steel 304/A2/1.4301 satin polished
for heavy duty offset doors, totally offset 35mm
for left hand (LH)
out of 3 pieces profile stainless steel 28,5x35mm
with each 1 hole for screw M10 or hexagon screw M8
all parts designed with black plastic
with black nylon rising mechanism, rising 8mm
with locked up pin stainless steel 304/A2 $\varnothing 9$ mm
automatical falling/selfclosing from 110° to 0°
maximum opening hook 180°
minimum door thickness 35mm
maximum door weight 80 Kg (2 hinges)
in boxes of 2 Pcs.

392272

heavy duty lift-off rising hinges, highness 215mm
stainless steel 304/A2/1.4301 satin polished
for heavy duty offset doors, totally offset 35mm
for right hand (RH)
out of 3 pieces profile stainless steel 28,5x35mm
with each 1 hole for screw M10 or hexagon screw M8
all parts designed with black plastic
with black nylon rising mechanism, rising 8mm
with locked up pin stainless steel 304/A2 $\varnothing 9$ mm
automatical falling/selfclosing from 110° to 0°
maximum opening hook 180°
minimum door thickness 35mm
maximum door weight 80 Kg (2 hinges)
in boxes of 2 Pcs.

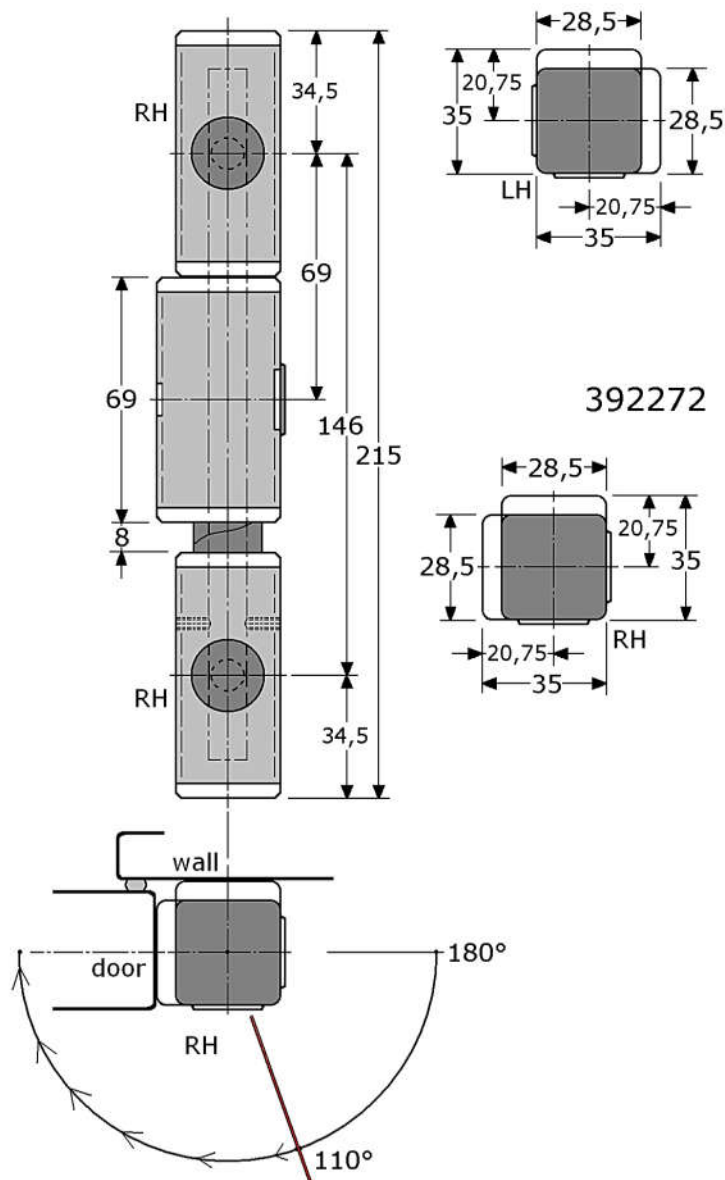

PIMEX B.V.
Coenecoop 131
2741 PJ WADDINXVEEN (NL)
Tel. (31) 182 - 61 11 66
Email: info@pimex.nl

PIROSTA-HINGES, stainless steel

complete stainless steel 316/A4/1.4401 satin polished
for TRESPA-plate 6-13mm
left & right changable
with removable stainless steel pin $\varnothing 7\text{mm}$,
blocked by security screw stainless steel 316/A4/1.4401 M4
only demounting possible if the door is already open
with stainless steel washer and stainless steel knobs
maximum door weight 25 Kg (3 hinges)
with countersunk screwholes (5mm/M5)

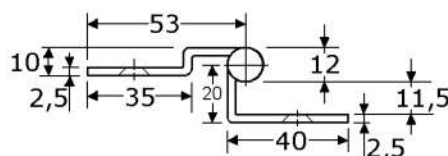
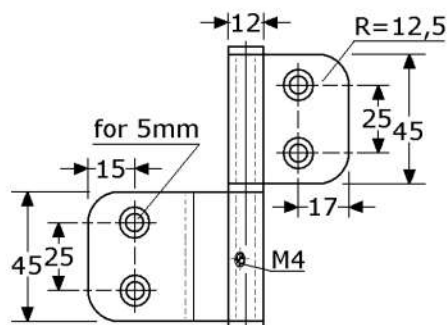

A4
316

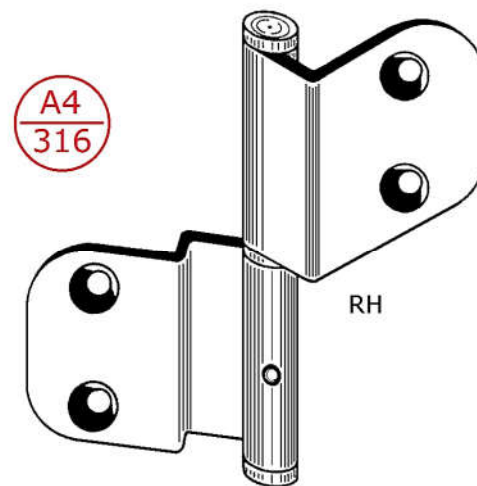
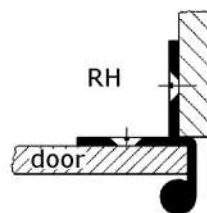

338243

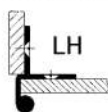

PIROSTA hinge for plate 6-10mm, LH
stainless steel 316/A4/1.4401 satin polished
highness 90mm, thickness 2,5mm, flush overlaid
with 2+2 countersunk screwholes (5mm/M5)
in boxes of 20 Pcs.

338244

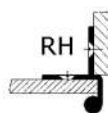

PIROSTA hinge for plate 6-10mm, RH
stainless steel 316/A4/1.4401 satin polished
highness 90mm, thickness 2,5mm, flush overlaid
with 2+2 countersunk screwholes (5mm/M5)
in boxes of 20 Pcs. (RH = as showed)

A4
316

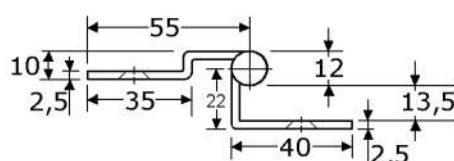

338245

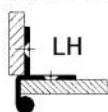

PIROSTA hinge for plate 12-13mm, LH
stainless steel 316/A4/1.4401 satin polished
highness 90mm, thickness 2,5mm, flush overlaid
with 2+2 countersunk screwholes (5mm/M5)
in boxes of 20 Pcs.

338246

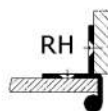

PIROSTA hinge for plate 12-13mm, RH
stainless steel 316/A4/1.4401 satin polished
highness 90mm, thickness 2,5mm, flush overlaid
with 2+2 countersunk screwholes (5mm/M5)
in boxes of 20 Pcs. (RH = as showed)

A4
316

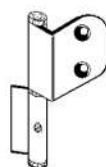
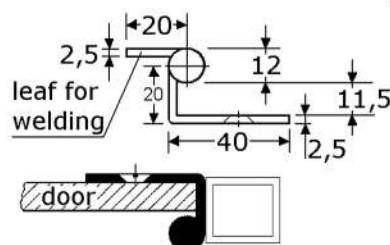

338241

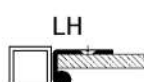

PIROSTA hinge for plate 6-10mm, LH
stainless steel 316/A4/1.4401 satin polished
highness 90mm, thickness 2,5mm, for inset door
with leaf 2,5mm for welding on profile
with 2 countersunk screwholes (5mm/M5)
in boxes of 20 Pcs.

338242

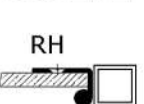

PIROSTA hinge for plate 6-10mm, RH
stainless steel 316/A4/1.4401 satin polished
highness 90mm, thickness 2,5mm, for inset door
with leaf 2,5mm for welding on profile
with 2 countersunk screwholes (5mm/M5)
in boxes of 20 Pcs. (RH = as showed)

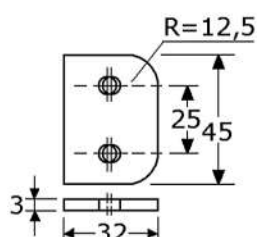

338259

PIROSTA distance plate out of 3mm white polyamide
for hinges 338241 - 338258
usable for upper part and under part
in boxes of 20 Pcs.



PIMEX B.V.
Coenecoop 131
2741 PJ WADDINXVEEN (NL)
Tel. (31) 182 - 61 11 66
Email: info@pimex.nl

PIROSTA-HINGES, stainless steel

complete stainless steel 316/A4/1.4401 satin polished
for TRESPA-plate 6-20mm
left & right changable
with removable stainless steel pin $\varnothing 7\text{mm}$,
blocked by security screw stainless steel 316/A4/1.4401 M4
only demounting possible if the door is already open
with stainless steel washer and stainless steel knobs
maximum door weight 25 Kg (3 hinges)
with countersunked screwholes (5mm/M5)

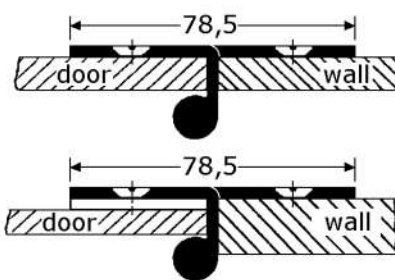
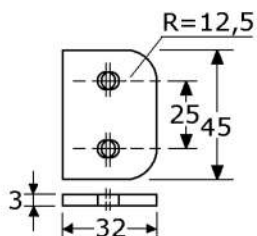
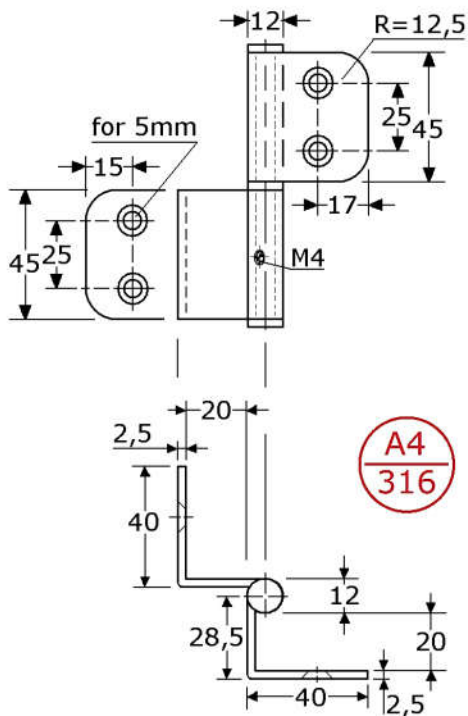

338257

PIROSTA hinge for plate 6-20mm, LH
stainless steel 316/A4/1.4401 satin polished
highness 90mm, thickness 2,5mm
for blind corners, for door and wall in line
for doors without direct side wall
also usable for thicker wall
for mounting only from backside
with 2+2 countersunked screwholes (5mm/M5)
in boxes of 20 Pcs.



338258

PIROSTA hinge for plate 6-20mm, RH
stainless steel 316/A4/1.4401 satin polished
highness 90mm, thickness 2,5mm
for blind corners, for door and wall in line
for doors without direct side wall
also usable for thicker wall
for mounting only from backside
with 2+2 countersunked screwholes (5mm/M5)
in boxes of 20 Pcs. (RH = as showed)



338259

PIROSTA distance plate out of 3mm white polyamide
for hinges 338241 - 338258
usable for upper part and under part
in boxes of 20 Pcs.

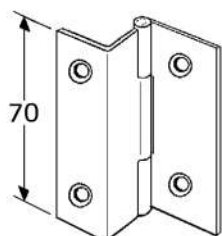

375203
(304)

see page GY-375a

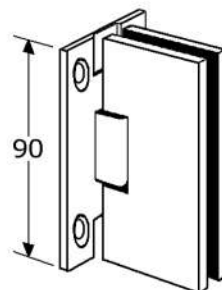

319212

(316)

see page GY-316a

870232
(304)

see page GY-871a

319271
(316)

see page GY-318a

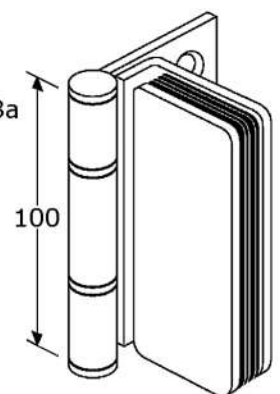
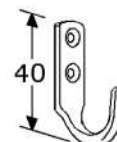

518211
(304)

see page GY-518

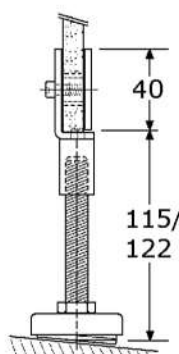

879232

(304/316)

see page
GY-879a/b

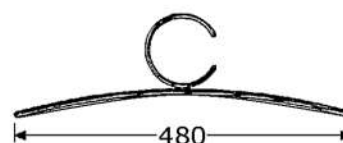

875211
(304)

see page GY-873



PIMEX B.V.

Coenecoop 131

2741 PJ WADDINXVEEN (NL)

Tel. (31) 182 - 61 11 66

Email: info@pimex.nl