

321201

rolled hinges with fixed riveted stainless steel pin
stainless steel 304/A2/1.4301, swaged
with 4 countersunk screwholes (3,5mm/M4)

h	x	w	x	t	fixed pin	boxes
40	x	40	x	2 mm	4 mm	50 Pcs

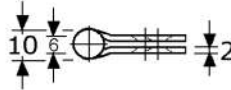
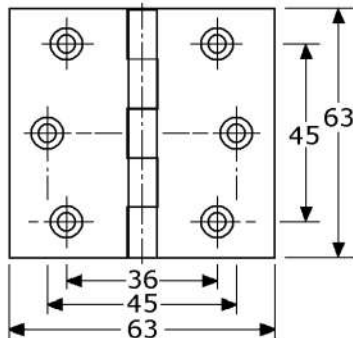

321224

rolled hinges with fixed riveted stainless steel pin
stainless steel 304/A2/1.4301, swaged
with 6 countersunk screwholes (4mm/M4)

h	x	w	x	t	fixed pin	boxes
63	x	63	x	2 mm	6 mm	25 Pcs

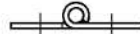
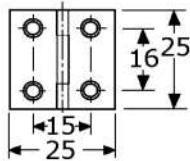

325212

rolled hinges with fixed riveted stainless steel pin
stainless steel 304/A2/1.4301, flat surface mounting
with 4 countersunk screwholes (2,5mm/M3)

h	x	w	x	t	fixed pin	boxes
25	x	25	x	1 mm	2 mm	50 Pcs

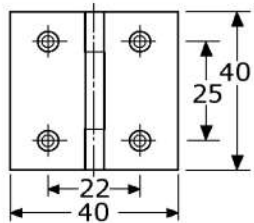

325232

rolled hinges with fixed riveted stainless steel pin
stainless steel 304/A2/1.4301, flat surface mounting
with 4 countersunk screwholes (2,5mm/M3)

h	x	w	x	t	fixed pin	boxes
40	x	40	x	1 mm	2,75 mm	50 Pcs

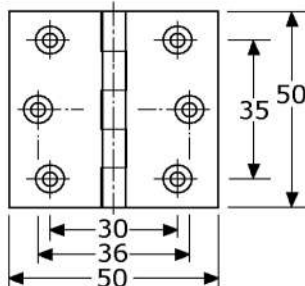

325252

rolled hinges with fixed riveted stainless steel pin
stainless steel 304/A2/1.4301, flat surface mounting
with 6 countersunk screwholes (3,5mm/M4)

h	x	w	x	t	fixed pin	boxes
50	x	50	x	1,25	2,75 mm	50 Pcs

(for hinges without screwholes, see page GY-340b)

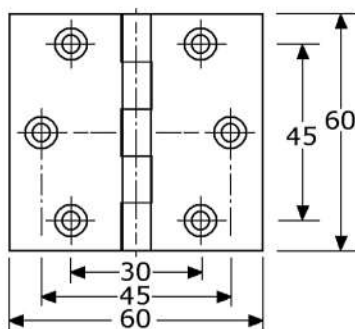

325262

rolled hinges with fixed riveted stainless steel pin
stainless steel 304/A2/1.4301, flat surface mounting
with 6 countersunk screwholes (3,5mm/M4)

h	x	w	x	t	fixed pin	boxes
60	x	60	x	1,5 mm	4 mm	25 Pcs



325271

325272

rolled hinges with fixed riveted (SS-316) pin
stainless steel 316/A4/1.4401, flat surface mounting
heavy duty, unpolished, 5-knuckles
with 6 countersunk screwholes (4,5mm/M5)

h	x	w	x	t	fixed pin	boxes
75	x	75	x	2,5 mm	6 mm	25 Pcs

like 325271, but stainless steel 316 satin polished
(for 345281 without screwholes, see page GY-340b)

for brass hinges, see page GF-424, etc.

for steel hinges, see page GF-440, etc.

for aluminium hinges, see page GF-451, etc.

for polyamide hinges, see page GF-468, etc.

HINGES WITH RIVETED PIN, stainless steel

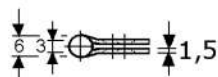
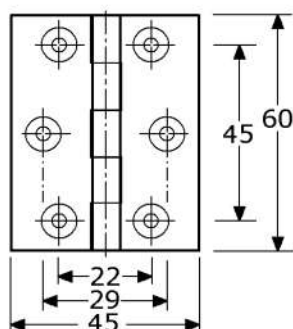

320212
320213

rolled hinges with fixed riveted stainless steel pin
stainless steel 304/A2/1.4301, swaged
with 6 countersunk screwholes (3,5mm/M4)

h	x	w	x	t	fixed pin	boxes
---	---	---	---	---	-----------	-------

60	x	45	x	1,5	3mm	50 Pcs
----	---	----	---	-----	-----	--------

like 320212, but with 6x drilled holes ø5,1mm
(on request/500 Pcs.)

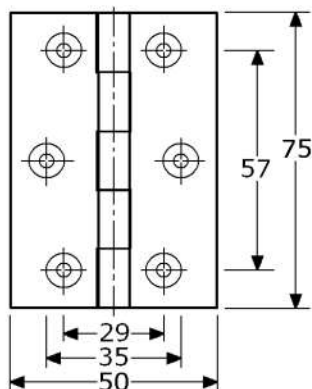

320222

rolled hinges with fixed riveted stainless steel pin
stainless steel 304/A2/1.4301, swaged
with 6 countersunk screwholes (3,5mm/M4)

h	x	w	x	t	fixed pin	boxes
---	---	---	---	---	-----------	-------

75	x	50	x	1,6	4mm (on request/250 Pcs.)	
----	---	----	---	-----	---------------------------	--

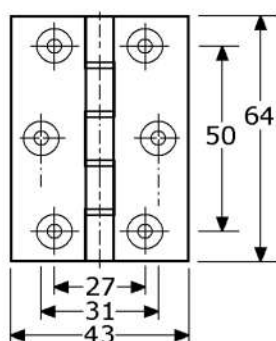

320264

rolled hinges with fixed riveted stainless steel pin
stainless steel 304/A2/1.4301, swaged
with 4 white polyacetal bushing ø6,3mm {RoHS}
knuckle ø6,3mm, space 1,5mm between leaves
with 6 countersunk screwholes (3,5mm/M4)

h	x	w	x	t	fixed pin	boxes
---	---	---	---	---	-----------	-------

64	x	43	x	1,3	3,5mm	50 Pcs
----	---	----	---	-----	-------	--------

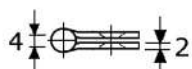
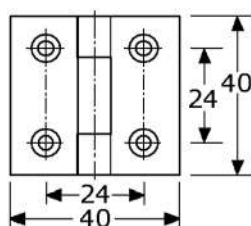

321201

rolled hinges with fixed riveted stainless steel pin
stainless steel 304/A2/1.4301, swaged
with 4 countersunk screwholes (3,5mm/M4)

h	x	w	x	t	fixed pin	boxes
---	---	---	---	---	-----------	-------

40	x	40	x	2	4 mm	50 Pcs
----	---	----	---	---	------	--------

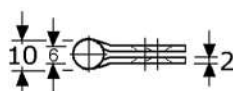
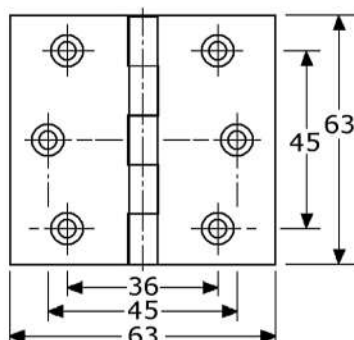

321224

rolled hinges with fixed riveted stainless steel pin
stainless steel 304/A2/1.4301, swaged
with 6 countersunk screwholes (4mm/M4)

h	x	w	x	t	fixed pin	boxes
---	---	---	---	---	-----------	-------

63	x	63	x	2	6 mm	25 Pcs
----	---	----	---	---	------	--------



PIMEX B.V.
Coenecoop 131
2741 PJ WADDINXVEEN (NL)
Tel. (31) 182 - 61 11 66
Email: info@pimex.nl

HINGES WITH RIVETED PIN, stainless steel

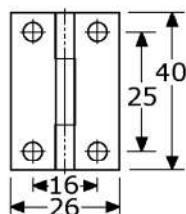

323230

rolled hinges with fixed riveted stainless steel pin
stainless steel 304/A2/1.4301
flat surface mounting, 3-knuckles
with 4 drilled screwholes $\varnothing 4,3$ mm

h	x	w	x	t	fixed pin	boxes
40	x	26	x	1 mm	2,5 mm	50 Pcs

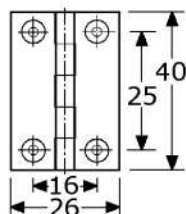

323232

rolled hinges with fixed riveted stainless steel pin
stainless steel 304/A2/1.4301
flat surface mounting, 5-knuckles
with 4 countersunk screwholes (3mm/M3/M4)

h	x	w	x	t	fixed pin	boxes
40	x	26	x	1 mm	2,5 mm	50 Pcs

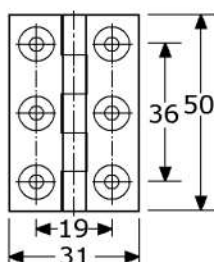

323262

rolled hinges with fixed riveted (SS-316/A4) pin
stainless steel 316/A4/1.4401
flat surface mounting, 5-knuckles
with 6 countersunk screwholes (3,5mm/M4)

h	x	w	x	t	fixed pin	boxes
50	x	31	x	1,25	2,75 mm	50 Pcs

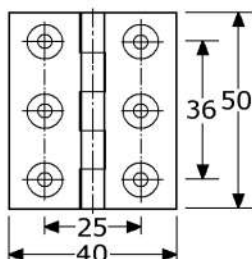

323274

rolled hinges with fixed riveted (SS-316/A4) pin
stainless steel 316/A4/1.4401
flat surface mounting, 5-knuckles
with 6 countersunk screwholes (3,5mm/M4)

h	x	w	x	t	fixed pin	boxes
50	x	40	x	1,25	2,75 mm	50 Pcs

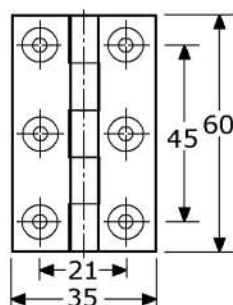

323292

rolled hinges with fixed riveted stainless steel pin
stainless steel 304/A2/1.4301
flat surface mounting, 5-knuckles
with 6 countersunk screwholes (3mm/M4)

h	x	w	x	t	fixed pin	boxes
60	x	35	x	1,5 mm	3mm	20 Pcs

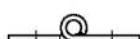
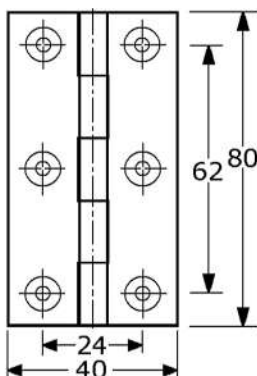

324232

rolled hinges with fixed riveted (SS-316/A4) pin
stainless steel 316/A4/1.4401
flat surface mounting, 5-knuckles
with 6 countersunk screwholes (3,5mm/M4)

h	x	w	x	t	fixed pin	boxes
80	x	40	x	1,5 mm	3,5mm	20 Pcs



PIMEX B.V.
Coenecoop 131
2741 PJ WADDINXVEEN (NL)
Tel. (31) 182 - 61 11 66
Email: info@pimex.nl

HINGES WITH RIVETED PIN, stainless steel

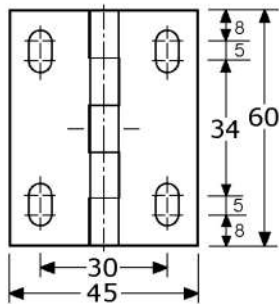

324260

rolled hinges with fixed riveted stainless steel pin
stainless steel 304/A2/1.4301
flat surface mounting, 5-knuckles
with 4 screwholes (for M5), height adjustable
delivery directly out of our stock

h	x	w	x	t	fixed pin	boxes
60	x	45	x	1,5 mm	3mm	50 Pcs

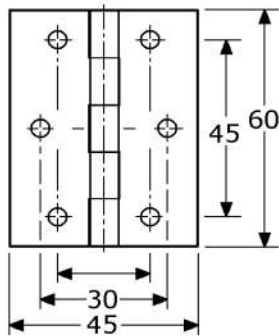

324253

rolled hinges with fixed riveted stainless steel pin
stainless steel 304/A2/1.4301
flat surface mounting, 5-knuckles
with 6 round holes $\varnothing 4,2$ mm
(not countersunk; for attaching rivets)
delivery on request (minimum quantity 1500 Pcs.)

h	x	w	x	t	fixed pin	boxes
60	x	45	x	1,5 mm	3mm	1500 Pcs

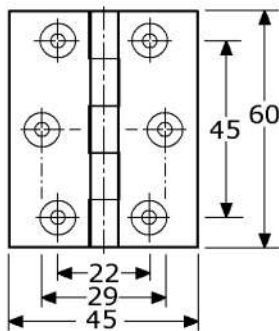

320212

rolled hinges with fixed riveted stainless steel pin
stainless steel 304/A2/1.4301
swaged rolled, 5-knuckles
with 6 countersunk screwholes (3,5mm/M4)
delivery directly out of our stock

h	x	w	x	t	fixed pin	boxes
60	x	45	x	1,5 mm	3mm	50 Pcs

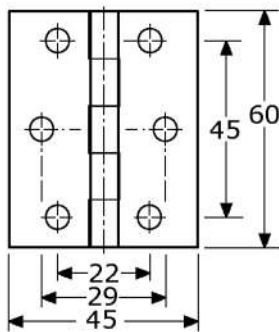

320213

rolled hinges with fixed riveted stainless steel pin
stainless steel 304/A2/1.4301
swaged rolled, 5-knuckles
with 6 round holes $\varnothing 5,1$ mm
(not countersunk; for attaching rivets)
delivery on request (minimum quantity 500 Pcs.)

h	x	w	x	t	fixed pin	boxes
60	x	45	x	1,5 mm	3mm	500 Pcs

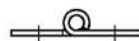
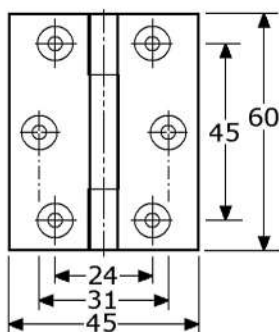

324263

rolled hinges with fixed riveted stainless steel pin
stainless steel 304/A2/1.4301
flat surface mounting, 3-knuckles
with 6 countersunk screwholes (4,5mm/M4)
delivery directly out of our stock

h	x	w	x	t	fixed pin	boxes
60	x	45	x	2 mm	4mm	50 stuks

on request there are also other possibilities for hinges with round holes



PIMEX B.V.
Coenecoop 131
2741 PJ WADDINXVEEN (NL)
Tel. (31) 182 - 61 11 66
Email: info@pimex.nl

HINGES WITH RIVETED PIN, stainless steel

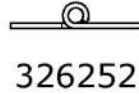
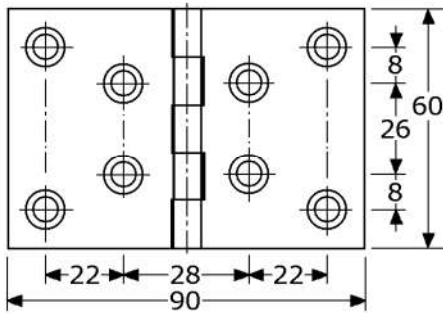

rolled back flap hinges with fixed riveted (SS) pin
stainless steel 304/A2/1.4301, flat surface mounting
with 8 countersunk screwholes (4mm/M4)

h	x	w	x	t	fixed pin	boxes
60	x	90	x	1,5	mm 3	20 Pcs

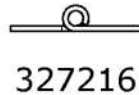
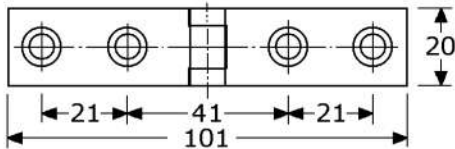

rolled back flap hinges with fixed riveted (SS) pin
stainless steel 304/A2/1.4301, flat surface mounting
with 4 countersunk screwholes (4,5mm/M5)

h	x	w	x	t	fixed pin	boxes
20	x	101	x	2	mm 5	50 Pcs

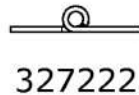
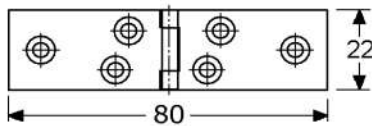

rolled back flap hinges with fixed riveted (SS) pin
stainless steel 304/A2/1.4301, flat surface mounting
with 6 countersunk screwholes (3mm/M3)

h	x	w	x	t	fixed pin	boxes
22	x	80	x	1,5	mm 3	50 Pcs

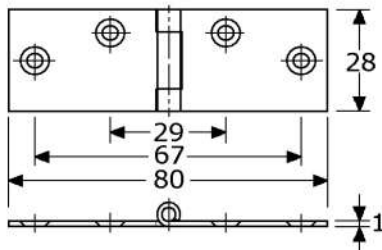

special type,
directly out of
our stock

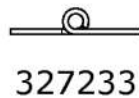

rolled back flap hinges with fixed riveted (SS) pin
stainless steel 304/A2/1.4301, 3-knuckles
flat surface mounting; special, but stock article !!!
with 2+2 countersunk screwholes (3mm/M3)

h	x	w	x	t	fixed pin	boxes
28	x	80	x	1	mm 4	25 Pcs

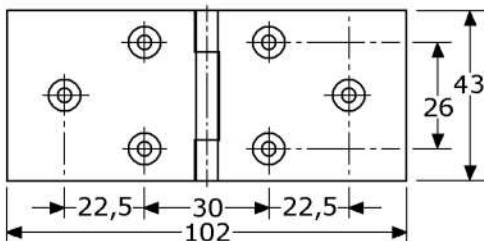

rolled back flap hinges with fixed riveted (SS) pin
stainless steel 304/A2/1.4301, flat surface mounting
with 6 countersunk screwholes (4mm/M4)

h	x	w	x	t	fixed pin	boxes
43	x	102	x	2	mm 4	50 Pcs

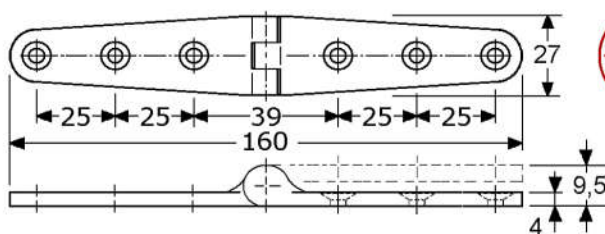

strap hinges with fixed stainless steel pin
stainless steel 316/A4/1.4401 mirror polished
flat surface mounting, 3-knuckles ø9,5mm
solid casting, no bearing
widthness 160mm (80+80mm)
with 6 countersunk screwholes (5mm/M5)

h	x	w	x	t	boxes
27	x	160	x	4	mm 20 Pcs

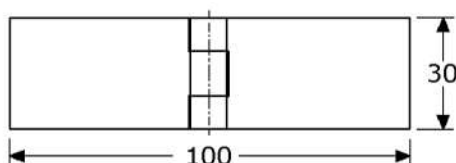

hinges without holes,
see page GY-341a



PIMEX B.V.
Coenecoop 131
2741 PJ WADDINXVEEN (NL)
Tel. (31) 182 - 61 11 66
Email: info@pimex.nl

HINGES WITH RIVETED PIN, stainless steel

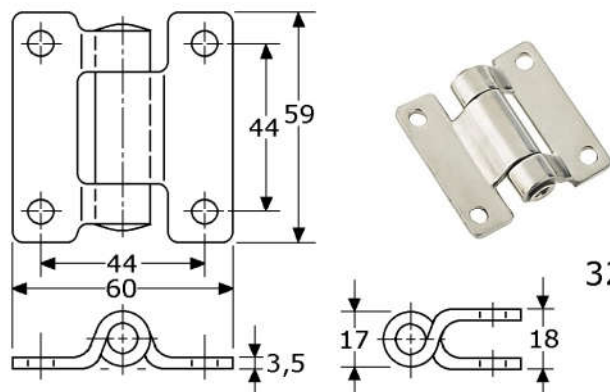

325298

rolled hinges with fixed riveted stainless steel pin
stainless steel 304/A2/1.4301
flat surface mounting, rolled, rounded
with 4 round holes $\varnothing 6,5\text{mm}$

h	x	w	x	t	fixed pin	boxes
59	x	60	x	3,5 mm	8 mm	20 Pcs

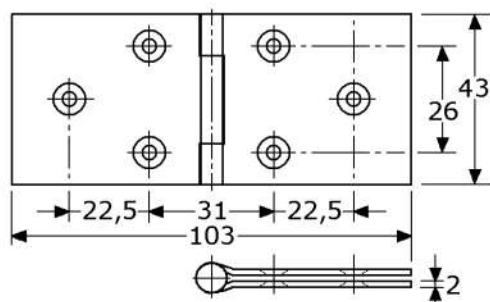

328242

rolled hinges with fixed riveted stainless steel pin
stainless steel 304/A2/1.4301, swaged
with 6 countersunk screwholes (4mm/M4)

h	x	w	x	t	fixed pin	boxes
43	x	103	x	2 mm	4 mm	50 Pcs

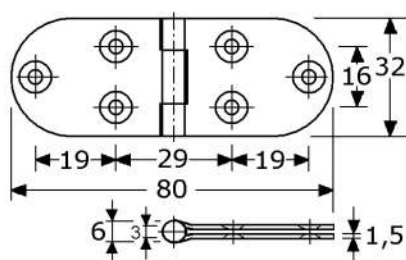

328294



rolled hinges with fixed riveted (SS-316/A4) pin
stainless steel 316/A4/1.4401 satin polished
swaged rolled, rounded, 3-knuckles
with 6 countersunk screwholes (3,5mm/M4)

h	x	w	x	t	fixed pin	boxes
32	x	80	x	1,5 mm	3 mm	50 Pcs

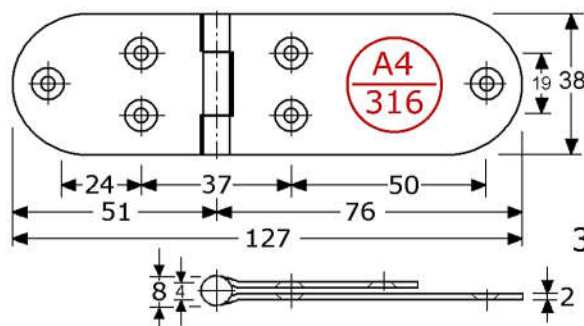

328296



rolled hinges with fixed riveted (SS-316/A4) pin
stainless steel 316/A4/1.4401 satin polished
swaged rolled, rounded, 3-knuckles
widthness 127mm (51+76mm)
with 6 countersunk screwholes (3,5mm/M4)

h	x	w	x	t	fixed pin	boxes
38	x	127	x	2 mm	4 mm	20 Pcs

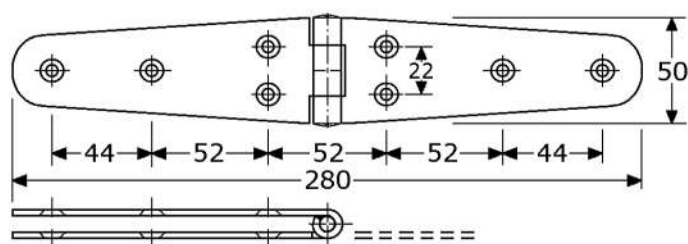

364208

364209



strap hinges with fixed stainless steel pin
stainless steel 316/A4/1.4401
flat surface mounting, rolled, tapped rounded leaves
with fixed riveted stainless steel pin, no bearing
widthness 280mm (140+140mm), 3-knuckles
with 8 countersunk screwholes (6mm/M6)

h	x	w	x	t	fixed pin	boxes
50	x	280	x	3 mm	6mm	10 Pcs

like 364208, but mirror polished



PIMEX B.V.
Coenecoop 131
2741 PJ WADDINXVEEN (NL)
Tel. (31) 182 - 61 11 66
Email: info@pimex.nl

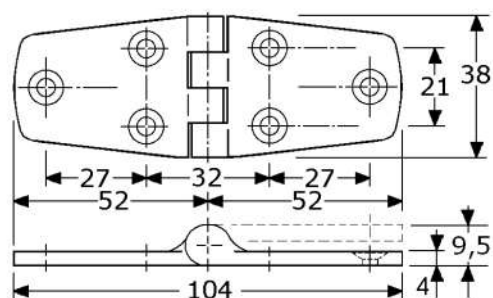

A4
316

329234

strap hinges with fixed stainless steel pin
stainless steel 316/A4/1.4401 mirror polished
solid casting, flat surface mounting, 4-knuckles
widthness 104mm (52+52mm)
with 6 countersunk screwholes (4,8mm/M5)

h	x	w	x	t	knuckle ø	boxes
38	x	104	x	4 mm	9,5 mm	20 Pcs

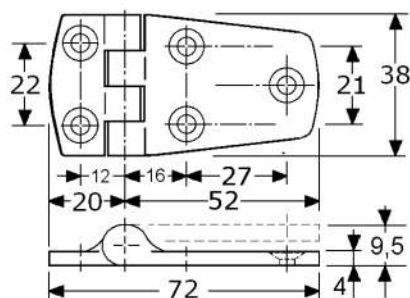

A4
316

329243

hinges with fixed stainless steel pin
stainless steel 316/A4/1.4401 mirror polished
solid casting, flat surface mounting, 4-knuckles
widthness 72mm (20+52mm)
with 5 countersunk screwholes (4,8mm/M5)

h	x	w	x	t	knuckle ø	boxes
38	x	72	x	4 mm	9,5 mm	20 Pcs

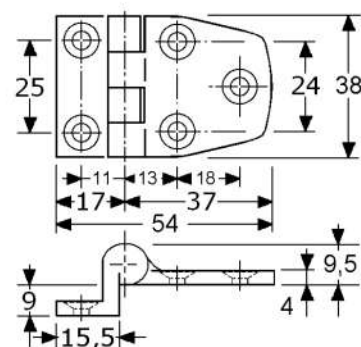

A4
316

329252

offset hinges with fixed stainless steel pin
stainless steel 316/A4/1.4401 mirror polished
solid casting, 4-knuckles
with 9,5mm offset
widthness 54mm (17+37mm)
with 5 countersunk screwholes (4,8mm/M5)

h	x	w	x	t	knuckle ø	boxes
38	x	54	x	4 mm	9,5 mm	20 Pcs

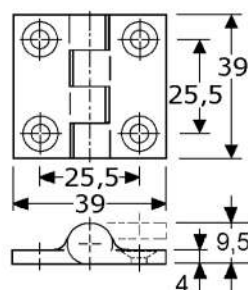

A4
316

329261

butt hinges with fixed stainless steel pin
stainless steel 316/A4/1.4401 mirror polished
solid casting, flat surface mounting, 4-knuckles
widthness 39mm, square
with 4 countersunk screwholes (4,8mm/M5)

h	x	w	x	t	knuckle ø	boxes
39	x	39	x	4 mm	9,5 mm	20 Pcs

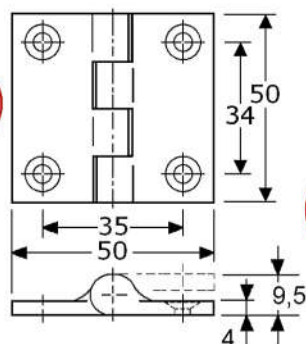

A4
316

329262

butt hinges with fixed stainless steel pin
stainless steel 316/A4/1.4401 mirror polished
solid casting, flat surface mounting, 4-knuckles
widthness 50mm, square
with 4 countersunk screwholes (4,8mm/M5)

h	x	w	x	t	knuckle ø	boxes
50	x	50	x	4 mm	9,5 mm	20 Pcs

for more measures
in stainless steel 316/A4
also types with smooth border,
see page GY-323b

for bigger measures
in stainless steel 316/A4,
see page GY-326



PIMEX B.V.
Coenecoop 131
2741 PJ WADDINXVEEN (NL)
Tel. (31) 182 - 61 11 66
Email: info@pimex.nl

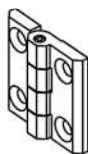
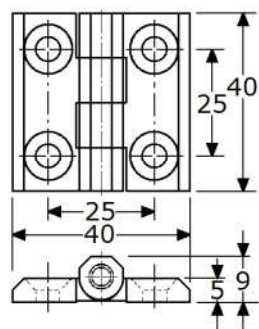

329259
329258
462810
492560

butt hinges with fixed SS-304 pin \varnothing 4mm
stainless steel 316/1.4571 satin polished
flat surface mounting, 4-knuckles
solid casting, smooth border
with 4 countersunk screwholes (5mm/M5)

h	x	w	x	t	knuckle \varnothing	boxes
40	x	40	x	5 mm	9mm	20 Pcs

same, SS-316, blind with 4x thread M5
same, but black polyamid (see page GF-468)
same, but zinc alloy black plated (see page GF-490)

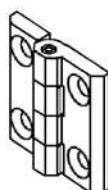
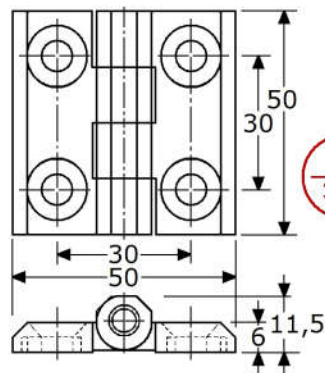

329264
462812
492564

butt hinges with fixed SS-304 pin \varnothing 6mm
stainless steel 316/1.4571 satin polished
flat surface mounting, 4-knuckles
solid casting (back not flat), smooth border
with 4 countersunk screwholes (6mm/M6)

h	x	w	x	t	knuckle \varnothing	boxes
50	x	50	x	6 mm	11,5mm	20 Pcs

same, but black polyamid (see page GF-468)
same, but zinc alloy black plated (see page GF-490)

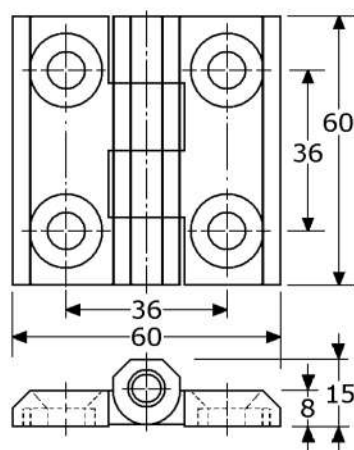

329266
492566

butt hinges with fixed SS-304 pin \varnothing 8mm
stainless steel 316/1.4571 satin polished
flat surface mounting, 4-knuckles
solid casting (back not flat), smooth border
with 4 countersunk screwholes (8mm/M8)

h	x	w	x	t	knuckle \varnothing	boxes
60	x	60	x	8 mm	15mm	10 Pcs

same, but zinc alloy black plated (see page GF-490)

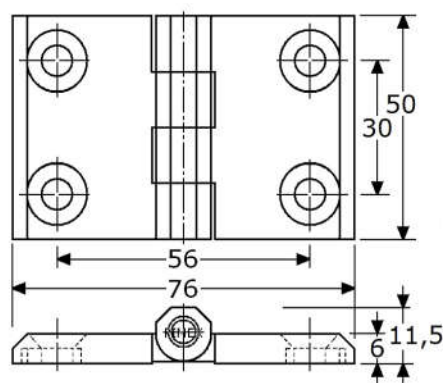

329268

butt hinges with fixed SS-304 pin \varnothing 6mm
stainless steel 316/1.4571 satin polished
flat surface mounting, 4-knuckles
solid casting (back not flat), smooth border
widthness 76mm (38+38mm)
with 4 countersunk screwholes (6mm/M6)

h	x	w	x	t	knuckle \varnothing	boxes
100	x	100	x	5,2mm	11,2mm	10 Pcs.

also directly out of our stock:

- 100x125x5,2mm with 8 screwholes (329287)
- 100x100x5,2mm with 2+2 screwholes (329285)
- 100x125x5,2mm without holes (342287)



PIMEX B.V.
Coenecoop 131
2741 PJ WADDINXVEEN (NL)
Tel. (31) 182 - 61 11 66
Email: info@pimex.nl

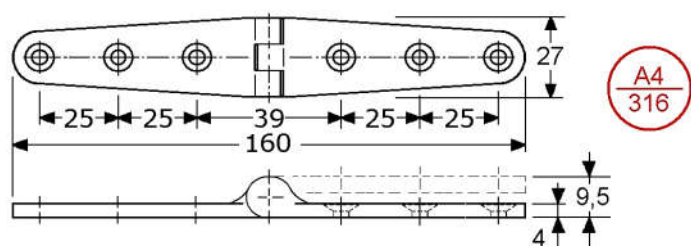

329276

strap hinges with fixed stainless steel pin
stainless steel 316/A4/1.4401 mirror polished
flat surface mounting, 3-knuckles $\varnothing 9,5\text{mm}$
solid casting, no bearing
widthness 160mm (80+80mm)
with 6 countersunk screwholes (5mm/M5)

h	x	w	x	t	boxes
27	x	160	x	4 mm	20 Pcs

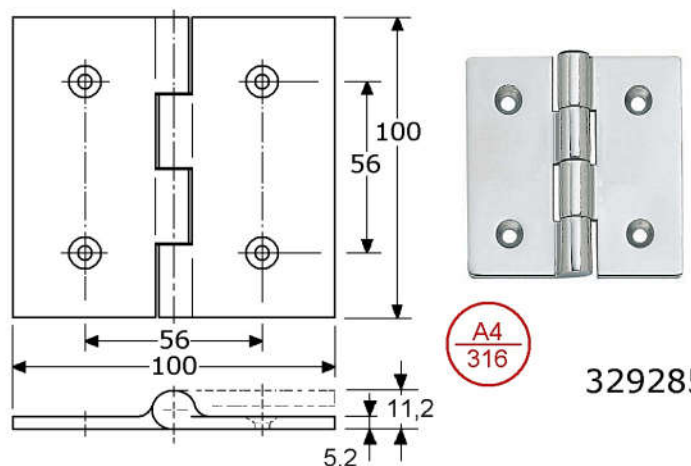

329285

butt hinges with fixed stainless steel pin
stainless steel 316/A4/1.4401 mirror polished
flat surface mounting, 4-knuckles $\varnothing 11,2\text{mm}$
solid casting, no bearing
widthness 100mm (50+50mm)
with 4 countersunk screwholes (5mm/M5)

h	x	w	x	t	boxes
100	x	100	x	5,2mm	10 Pcs

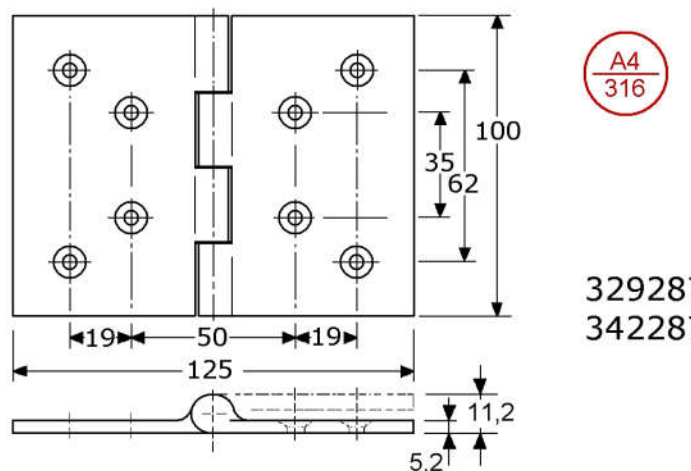

329287
342287

butt hinges with fixed stainless steel pin
stainless steel 316/A4/1.4401 mirror polished
flat surface mounting, 4-knuckles $\varnothing 11,2\text{mm}$
solid casting, no bearing
widthness 125mm ($62\frac{1}{2} + 62\frac{1}{2}\text{mm}$)
with 8 countersunk screwholes (5mm/M5)

h	x	w	x	t	boxes
100	x	125	x	5,2mm	10 Pcs
like 329287, but without holes					10 Pcs

(see also page GY-342a)

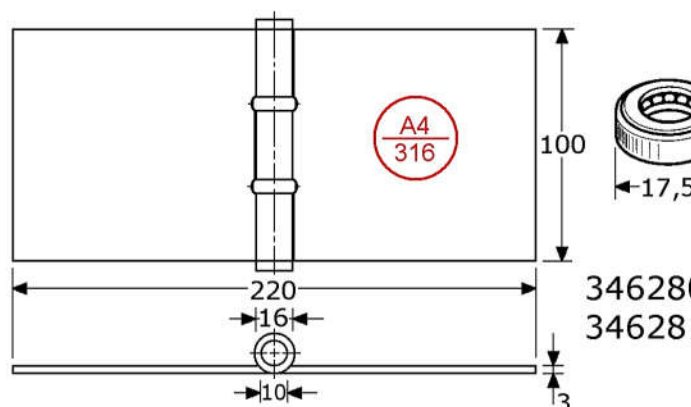

346280
346281

rolled hinges with LOOSE stainless steel pin $\varnothing 10\text{mm}$
stainless steel 316/A4/1.4401 satin polished
flat surface mounting, 3-knuckles $\varnothing 16\text{mm}$
pin & buttom tip out of stainless steel 316/A4
with each 2 ball bearings stainless steel $\varnothing 17,5\text{mm}$
(outside & inside SS-304/A2, balls SS-420 hardened)
without screwholes

h	x	w	x	t	loose pin	boxes
100	x	220	x	3 mm	10 mm	10 Pcs
like 346280, but with SS-316 washers						



PIMEX B.V.
Coenecoop 131
2741 PJ WADDINXVEEN (NL)
Tel. (31) 182 - 61 11 66
Email: info@pimex.nl

HINGES WITH RIVETED PIN, stainless steel

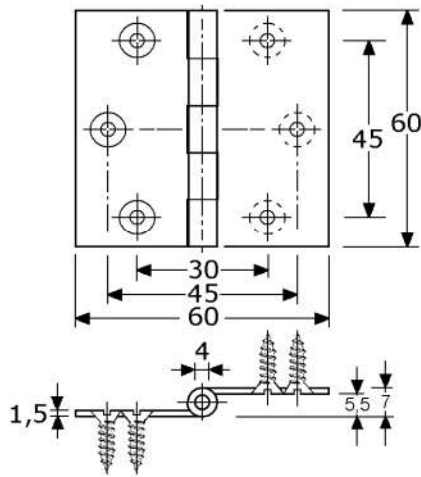

325269

hinges with fixed riveted (SS) pin
stainless steel 304/A2/1.4301, 3-knuckles
contra mounted with 5,5mm offset
special type & directly out of our stock ###
with 6 countersunk screwholes (3,5mm/M4)

h x w x t	fixed pin	boxes
60 x 60 x 1,5 mm	4 mm	25 Pcs

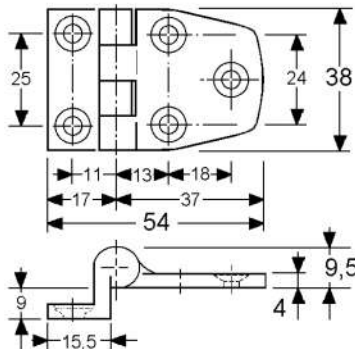

329252

offset hinges with fixed stainless steel pin
stainless steel 316/A4/1.4401 mirror polished
solid casting, 4-knuckles
with 9,5mm offset
width 54mm (17+37mm)
with 5 countersunk screwholes (4,8mm/M5)

h x w x t	knuckle ø	boxes
38 x 54 x 4 mm	9,5 mm	20 Pcs

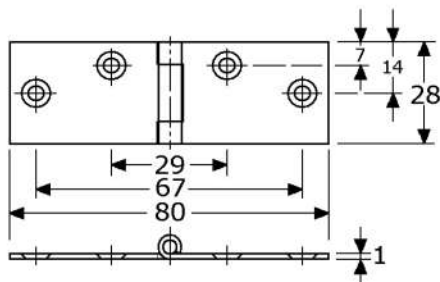

327233

rolled back flap hinges with fixed riveted (SS) pin
stainless steel 304/A2/1.4301, 3-knuckles
flat surface mounting; special, but stock article !!!
special type & directly out of our stock ###
with 2+2 countersunk screwholes (3mm/M3)

h x w x t	fixed pin	boxes
28 x 80 x 1 mm	4 mm	25 Pcs

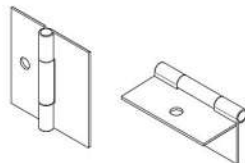
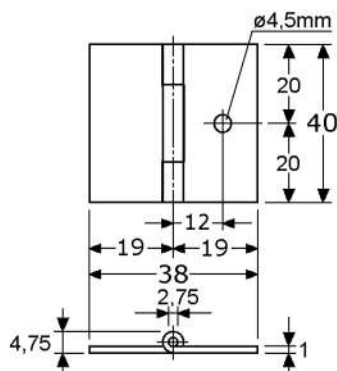

345228

hinges with fixed riveted (SS) pin
stainless steel 304/A2/1.4301, 3-knuckles
flat surface mounting; special, but stock article !!!
special type & directly out of our stock ###
with only 1 screwhole ø4,5mm

h x w x t	fixed pin	boxes
40 x 38 x 1 mm	2,75 mm	50 Pcs

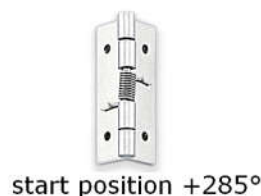
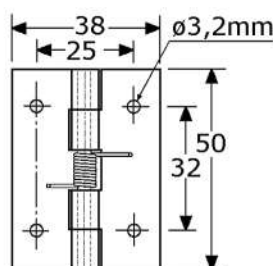

386248

hinges with stainless steel spring ø0,9mm
stainless steel 304/A2, 5-knuckles
flat, not strengthen
spring goes back to start position +285°
possibility to full open (can by hand) to +0°
indication spring torsion: first 90° = 1,5 Kg (15 N)
with 4 round screwholes ø3,2mm

h x w x t	fixed pin	boxes
50 x 38 x 1,5 mm	3mm	20 Pcs

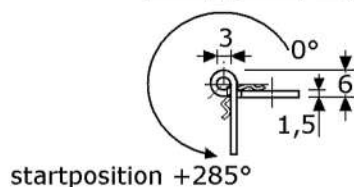

PIMEX B.V.
Coenecoop 131
2741 PJ WADDINXVEEN (NL)
Tel. (31) 182 - 61 11 66
Email: info@pimex.nl