

HINGES

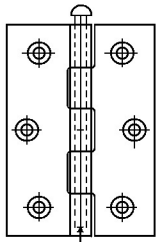

stainless steel
with loose pin,
page GY-304



stainless steel,
page GY-374a



stainless steel,
page GY-316a

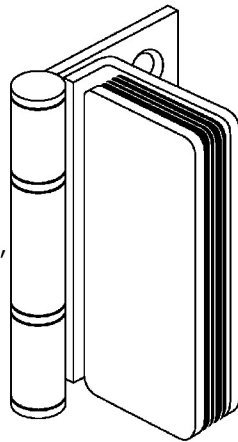

stainless steel 316,
page GY-318a

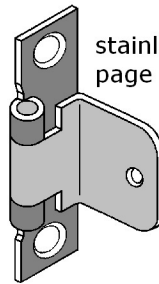

stainless steel,
page GY-374b



stainless steel 316,
page GY-316a



stainless steel 316
with revited pin,
page GY-323a



stainless steel
self-closing,
page GY-336a



stainless steel,
page GY-330



stainless steel,
GY-382a



stainless steel,
with revited pin,
page GY-320a



stainless steel,
page GY-364



stainless steel without holes,
page GY-340a

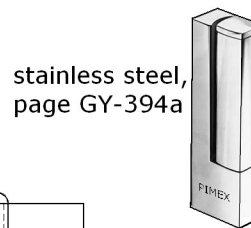

stainless steel,
page GY-394a



stainless steel,
page GY-378a



stainless steel,
page GY-380a

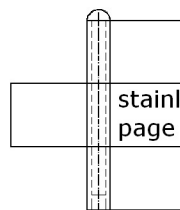

stainless steel,
page GY-343a

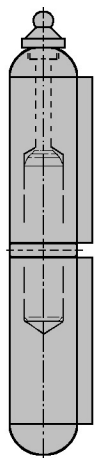

weld-on hinges
stainless steel,
page GY-348a

stainless steel 316,
page GY-349a

aluminium,
page GF-450 (group 04)

steel,
page GF-449a (group 04)

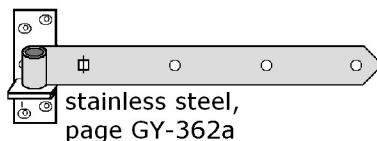

stainless steel,
page GY-362a



stainless steel
soft-closing,
page GY-387a



pianohinges
stainless steel (316),
page GY-350

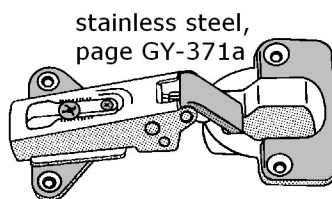

stainless steel,
page GY-371a

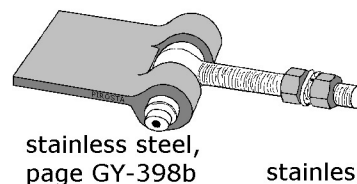

stainless steel,
page GY-398b

stainless steel,
page GY-397a



stainless steel,
page GY-392a



stainless steel,
page GY-377a



stainless steel,
page GY-395b



PIMEX B.V.
Coenecoop 131
2741 PJ WADDINXVEEN (NL)
Tel. (31) 182 - 61 11 66
Email: info@pimex.nl