

**TELESCOPIC SLIDES, aluminium alloy**

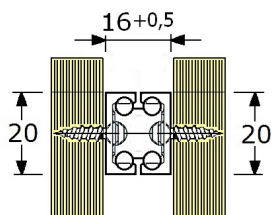
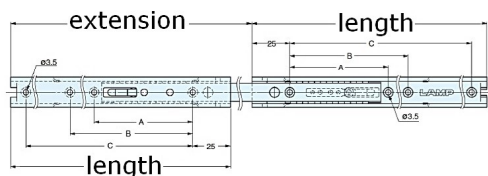

916550  
916551  
916553

precision ball bearing slides  
aluminium alloy profile  
full (over) extension slide, extension lengths 100%  
space require 16mm, low highness 20mm, side mounting  
\*\*\*\*  
first quality, with fine steel ball bearing  
can not be disconnected, non handed  
full opened the drawer will be blocked in locking device  
for lightweight use  
with countersunk screwholes (3mm)  
\*\*\*\*  
delivery on request (A)

type	length	extension	width	load capacity	per
AR3-K	200mm	214mm	16mm	13 Kg/Pr A	15 Pr
AR3-K	300mm	314mm	16mm	11 Kg/Pr A	15 Pr
AR3-K	400mm	414mm	16mm	9 Kg/Pr	15 Pr

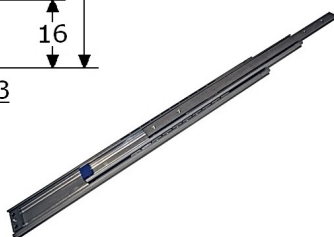
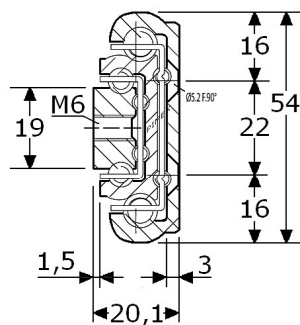

917546

precision ball bearing slides  
aluminium alloy profile  
full extension slide, extension lengths 100%  
space require 20,1mm, highness 54mm, side mounting  
with steel ball bearing  
can not be disconnected, non handed  
load capacity based on normal vertical (drawer) use  
the outer rail: with double holes for 5mm  
the inner rail: with single tapped holes M6  
sales by pair (but left & right are the same)  
delivery on request (A)

type	length	extension	width	load capacity	per
(D500)	1000mm	1010mm	20,1mm	43 Kg/Pr	1 Pr

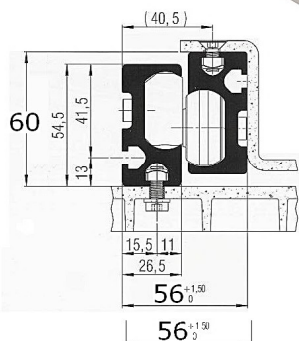

919505

heavy duty drawer slides  
aluminium alloy profile  
single extension 70%  
space required 56mm, highness required 60mm  
\*\*\*\*  
with 4x big nylon rollers ø33mm (movable)  
for high loading  
for side mounting, top mounting or base mounting  
with (loose) bolt steel zinc plated M6x20  
with (loose) nut steel zinc plated M6  
with (loose) Abkippsicherung (mounted: not disconnected)

type	length	extension	width	load capacity	per
(A900)	500mm	350mm	56mm	200 Kg/Pr	1 Pr



**PIMEX B.V.**  
Coenecoop 131  
2741 PJ WADDINXVEEN (NL)  
Tel. (31) 182 - 61 11 66  
Email: info@pimex.nl



**925503** rotary ring/swivel, outside  $\varnothing 326\text{mm}$  aluminium alloy/profile, highness 16mm with big steel ball bearing, for 60 Kg rotary 360° without stop (not demontable) with white rubber stoppers prevent slipping top ring has 6 countersunk holes to fix on table in boxes of 1 Pcs.

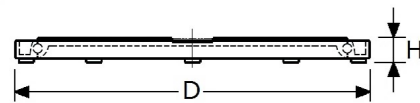

**925505** rotary ring/swivel, outside  $\varnothing 442\text{mm}$  aluminium alloy/profile, highness 22mm with big steel ball bearing, for 100 Kg rotary 360° without stop (not demontable) with white rubber stoppers prevent slipping top ring has 6 countersunk holes to fix on table in boxes of 1 Pcs.

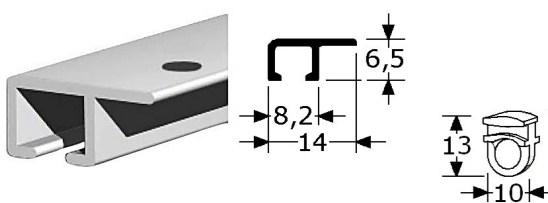

**941501** curtain rail 14x6,5mm aluminium profile small type, for yacht interior use in boxes of 100 Mtr (20 Pcs. of 5 meter)

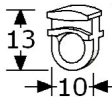

**941503** curtain rail runners white nylon (only in boxes of 1000 Pcs.)



**941506** curtain rail end stops steel nickel (only in boxes of 100 Pcs.)

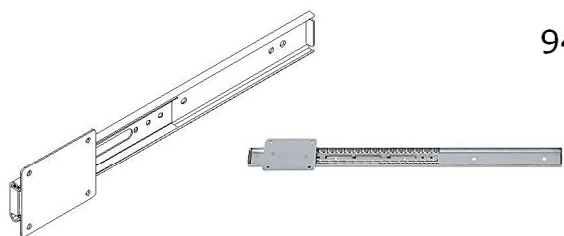

**943221** linear ball bearing guide rails 310mm stainless steel 304/A2, inbouwbreedte 11mm with small ball bearing stainless steel 304/A2 highness 35/60mm, max. loading 5 Kg/Pr (vertical) with stainless steel rail guide plate 80x60mm rail with 4 holes, rail guide plate with 4 holes  $\varnothing 4,5\text{mm}$  (in pieces; attention: only small stock)



**943522** guide rails 200mm with widthness 20mm aluminium anodised profile, highness 8,2mm highness 8,2mm, max. loading 15 Kg/Pr (vertical) (delivery on request; also possible 400/800mm)

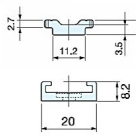

**943529** guide 50x16,8mm for guide rails 20mm grey polyethylen with 2x stainless steel inserts M4 (delivery on request)



**943532** guide rails 200mm with widthness 30mm aluminium anodised profile, highness 10mm highness 10mm, max. loading 15 Kg/Pr (vertical) (delivery on request; also possible 400/800mm)

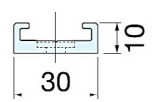

**943539** guide 50x26mm for guide rails 30mm grey polyethylen with 2x stainless steel inserts M4 (delivery on request)



**PIMEX B.V.**  
Coenecoop 131  
2741 PJ WADDINXVEEN (NL)  
Tel. (31) 182 - 61 11 66  
Email: info@pimex.nl