



PIMEX advice the PIWAX latch 650251 in stainless steel 316/A4 with triangular  8mm see page GY-650a

for longer triangular latches:  
see page GY-650b for length 36mm (650253)  
see page GY-650c for length 50mm (650254)  
see page GY-650d for length 80mm (650256)

PIMEX has also very nice latches with 6mm compression (653452/653453) in stainless steel 316/A4 with triangular  8mm see page GY-653a

if there is not so much space, then the mini latch in stainless steel is a solution

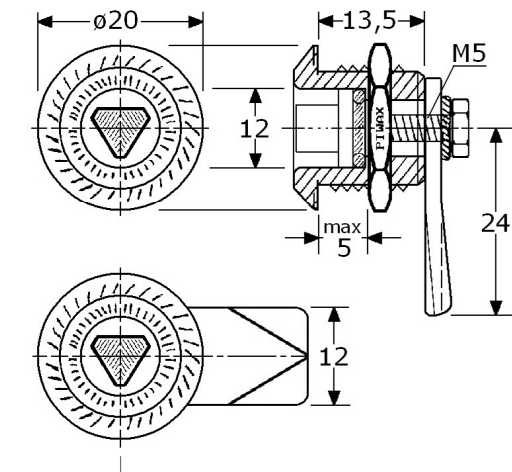

646202

mini latch with triangular  6,5mm stainless steel 316/A4/1.4401 water and dust tight, no packing/gasket small short type, body length 13,5mm for use door thickness 1-5mm with stainless steel 304/A2 nut M16 with stainless steel 304/A2 bolt M5 for LH and RH assembly backside: #6x6mm, for 90° action limited (keys & cams have to be ordered separately) hole pattern: #14,1mm/16,3mm mounting: a complete assembled latch can be pushed through the hole in the door in boxes of 25 Pcs.

A4  
316

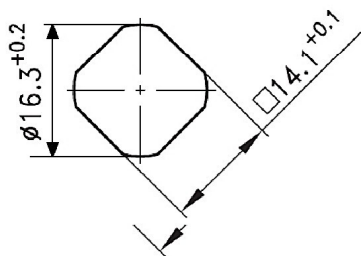

646208

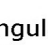
key length 65mm for triangular  6,5mm zinc alloy nickel plated, with oval eye

cams for mini triangular latches 646202:

646277

cam stainless steel 304/A2 -6mm, conical with nock length (till centre) 24mm, width 12mm thickness 2mm, for -6mm (13,5-6=7,5mm)

646280

cam stainless steel 304/A2 0mm, conical with nock length (till centre) 24mm, width 12mm thickness 2mm, for +0mm (13,5+0=13,5mm)

646283

cam stainless steel 304/A2 +6mm, conical with nock length (till centre) 24mm, width 12mm thickness 2mm, for +6mm (13,5+6=19,5mm)

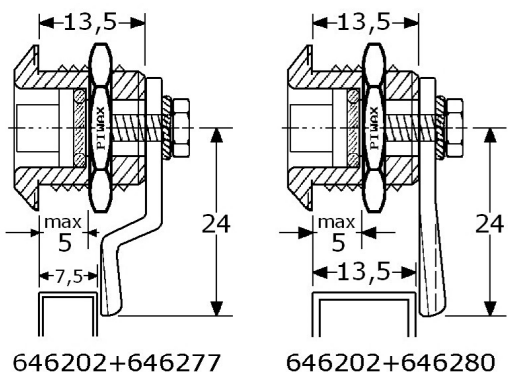

646202+646277

646202+646280



646202+646283



PIMEX B.V.  
Coenecoop 131  
2741 PJ WADDINXVEEN (NL)  
Tel. (31) 182 - 61 11 66  
Email: info@pimex.nl

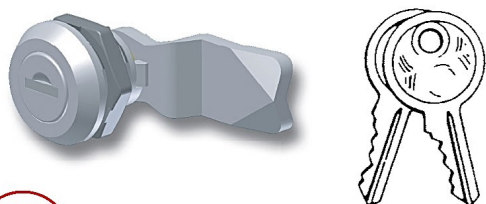

647232

PIWAX cylinder lock, body length 18mm  
stainless steel 316/A4/1.4401  
for use door thickness 1-8mm  
stainless steel 316/A4 5-disc tumblers cylinder  
with each 2 steel nickel keys, key different  
in closed&open position is the key removable  
with each 1 black packing/gasket  $\varnothing 28 \times 0,8 \text{ mm}$   
with each 1 nut stainless steel M22  
for LH and RH assembly and usable as down lock  
hole pattern #20,1mm/ $\varnothing 22,5 \text{ mm}$   
backside #8x8mm with bolt M6  
for 90° action limited (using cam with nock)  
(cams to be ordered separately)  
mounting: a complete assembled latch can be  
pushed through the hole in the door  
in boxes of 6 Pcs.

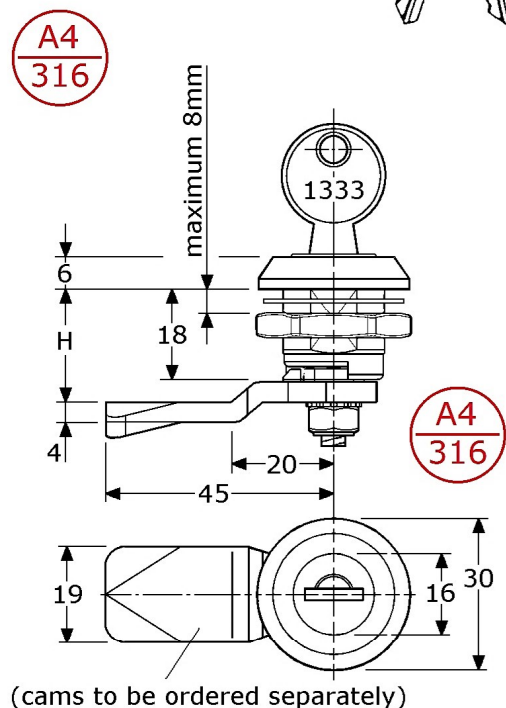

647233

PIWAX cylinder lock, body length 18mm  
stainless steel 316/A4/1.4401  
for use door thickness 1-8mm  
stainless steel 316/A4 5-disc tumblers cylinder  
with each 2 steel nickel keys, key alike (code 1333)  
in closed&open position is the key removable  
with each 1 black packing/gasket  $\varnothing 28 \times 0,8 \text{ mm}$   
with each 1 nut stainless steel M22  
for LH and RH assembly and usable as down lock  
hole pattern #20,1mm/ $\varnothing 22,5 \text{ mm}$   
backside #8x8mm with bolt M6  
for 90° action limited (using cam with nock)  
(cams to be ordered separately)  
mounting: a complete assembled latch can be  
pushed through the hole in the door  
in boxes of 6 Pcs.

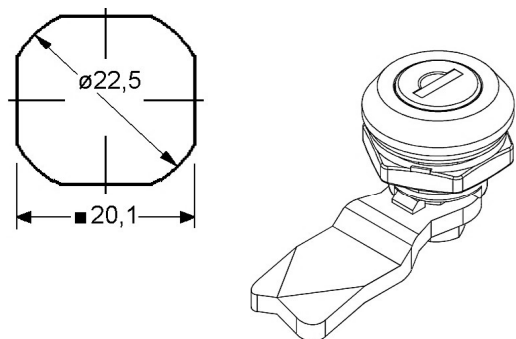

different cams (thickness 4mm) for  
different situations:

650279	PIWAX cam	(316/A4) -12mm back	(18-12=6mm)
650310	PIWAX cam	(304/A2) -8mm back	(18-8=10mm)
650314	PIWAX cam	(304/A2) -4mm back	(18-4=14mm)
650280	PIWAX cam	(316/A4) 0mm flat	(18+0=18mm)
650281	PIWAX cam	(316/A4) +4mm	(18+4=22mm)
650324	PIWAX cam	(304/A2) +6mm	(18+6=24mm)
650326	PIWAX cam	(304/A2) +8mm	(18+8=26mm)
650282	PIWAX cam	(316/A4) +10mm	(18+10=28mm)
650330	PIWAX cam	(304/A2) +12mm	(18+12=30mm)
650332	PIWAX cam	(304/A2) +14mm	(18+14=32mm)

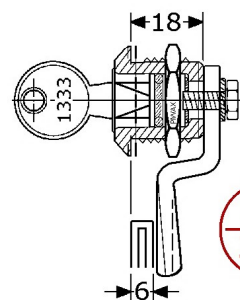

lock+650279

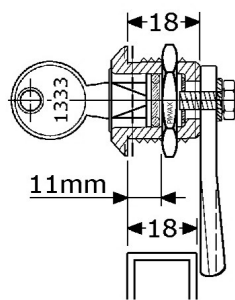

lock+650280

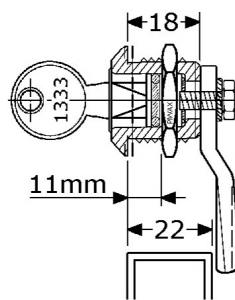

lock+650281

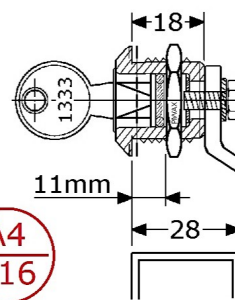

lock+650282

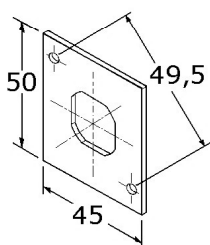

in stock we have  
mounting plates in  
stainless steel 316/A4  
with 2 holes  $\varnothing 4 \text{ mm}$  (650293)  
or without holes (650295),  
see page GY-651a



**PIWAX B.V.**  
Coenecoop 131  
2741 PJ WADDINXVEEN (NL)  
Tel. (31) 182 - 61 11 66  
Email: info@pimex.nl



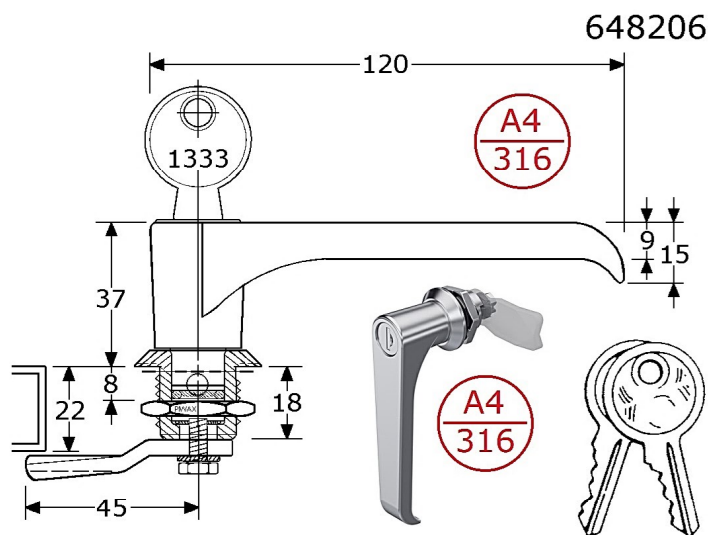

PIWAX "L"-handle length 120mm, with cylinder stainless steel 316/A4 satin polished body length 18mm, for maximum 8mm plate with brass nickel cylinder with each 2 steel nickel keys, key alike (code 1333) in closed&open position is the key removable with each 1 black packing/gasket  $\varnothing 28 \times 0,8$ mm with each 1 nut stainless steel M22 backside: #8x8mm, for 90° action limited (cams have to be ordered separately) in boxes of 6 Pcs.

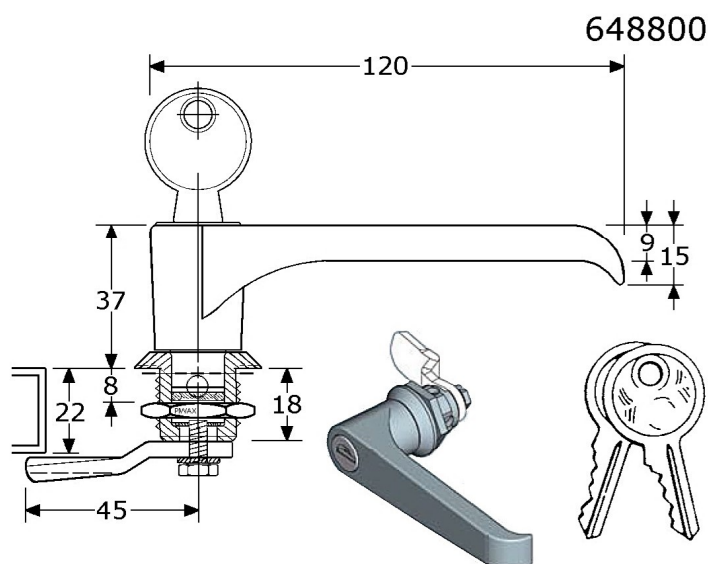
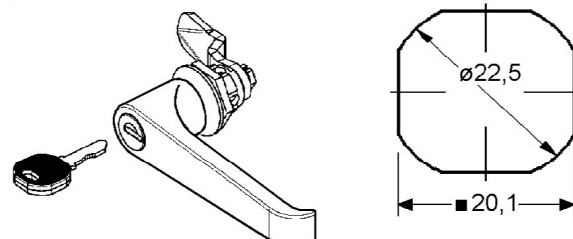

PIWAX "L"-handle black polyamid L=120mm with black zinc alloy body body length 18mm, for maximum 8mm plate with brass nickel cylinder with each 2 steel nickel keys, key alike (code 1333) in closed&open position is the key removable with each 1 black packing/gasket  $\varnothing 28 \times 0,8$ mm with each 1 nut steel zinc plated M22 backside: #8x8mm, for 90° action limited (cams have to be ordered separately) in boxes of 6 Pcs.

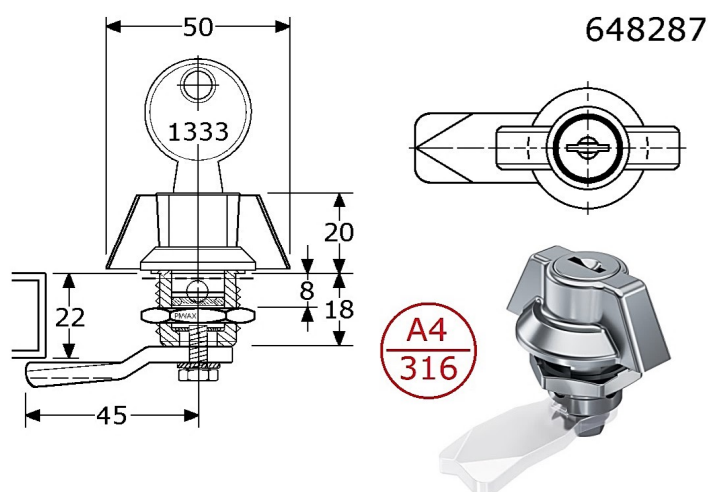
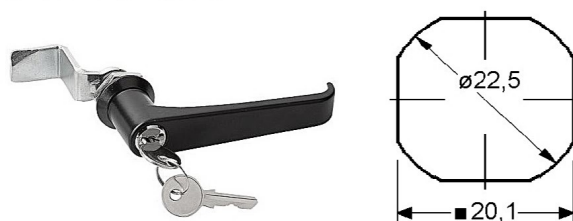

PIWAX wing handle 50mm, with cylinder stainless steel 316/A4 satin polished body length 18mm, for maximum 8mm plate with brass nickel cylinder with each 2 steel nickel keys, key alike (code 1333) in closed&open position is the key removable with each 1 black packing/gasket  $\varnothing 28 \times 0,8$ mm with each 1 nut stainless steel M22 backside: #8x8mm, for 90° action limited (cams have to be ordered separately) in boxes of 6 Pcs.

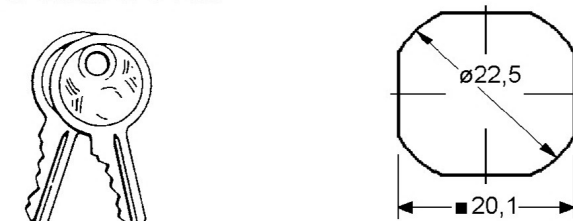

to get to a nut #8mm which is deeper, PIMEX has a special square spindle (839287) out of stainless steel 316/A4 #8x50/58mm with M6 at the end

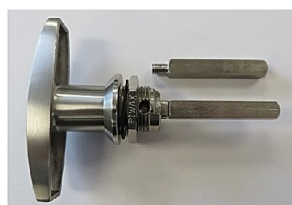

**PIMEX B.V.**  
Coenecoop 131  
2741 PJ WADDINXVEEN (NL)  
Tel. (31) 182 - 61 11 66  
Email: info@pimex.nl

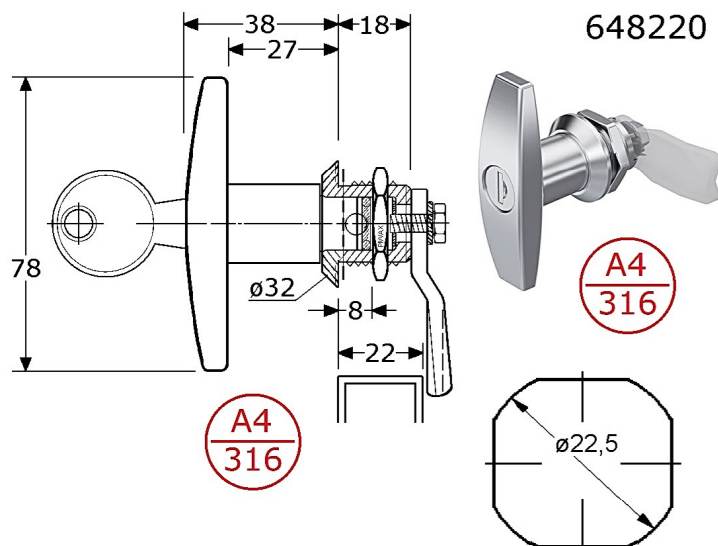

**648220**

PIWAX "T"-handle 78mm, with brass nickel cylinder stainless steel 316/A4 satin polished body length 18mm, for maximum 8mm plate with each 2 steel nickel keys, key different in closed&open position is the key removable with each 1 black packing/gasket  $\varnothing 28 \times 0,8$ mm with each 1 nut stainless steel M22 backside: #8x8mm, for 90° action limited (cams have to be ordered separately) in boxes of 6 Pcs.

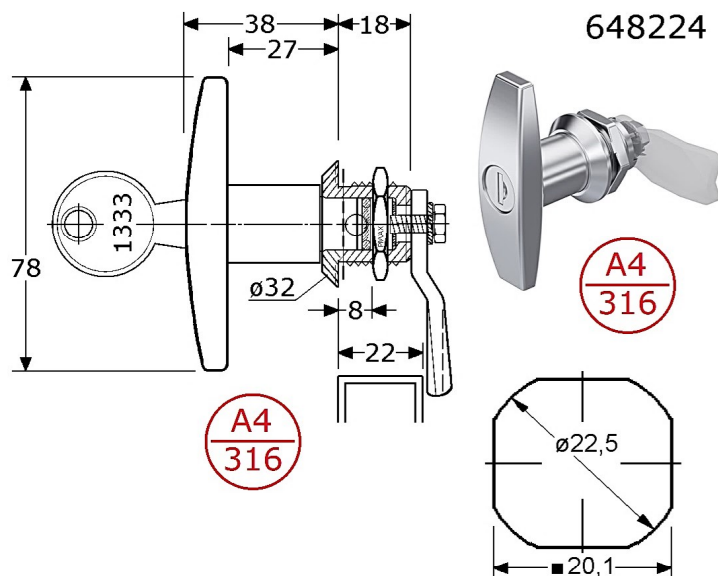
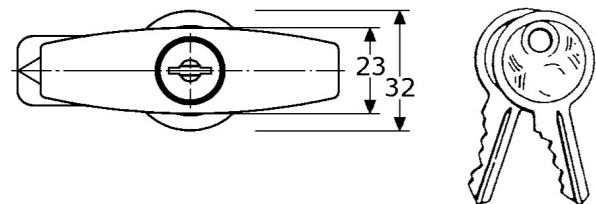

**648224**

PIWAX "T"-handle 78mm, with brass nickel cylinder stainless steel 316/A4 satin polished body length 18mm, for maximum 8mm plate with each 2 steel nickel keys, key alike (code 1333) in closed&open position is the key removable with each 1 black packing/gasket  $\varnothing 28 \times 0,8$ mm with each 1 nut stainless steel M22 backside: #8x8mm, for 90° action limited (cams have to be ordered separately) in boxes of 6 Pcs.

also possible: - zinc alloy chrome plated (648123)

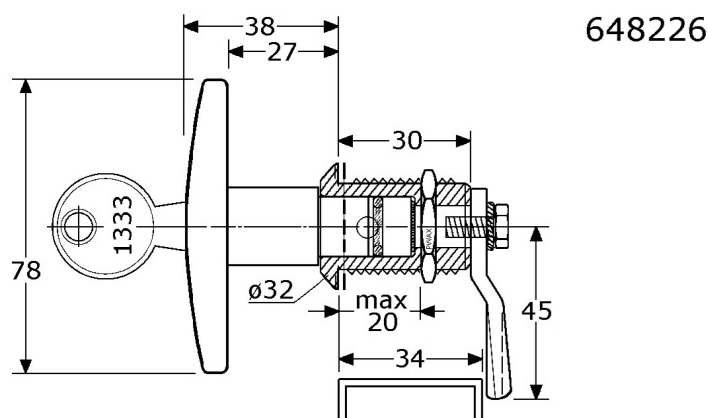
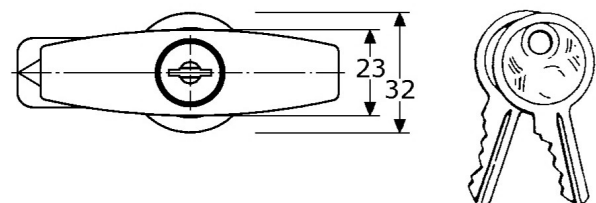

**648226**

PIWAX "T"-handle 78mm, with brass nickel cylinder stainless steel 304/A2 satin polished body length 30mm, for maximum 20mm plate with each 2 steel nickel keys, key alike (code 1333) in closed&open position is the key removable with each 1 black packing/gasket  $\varnothing 28 \times 0,8$ mm with each 1 nut stainless steel M22 backside: #8x8mm, for 90° action limited (cams have to be ordered separately) in boxes of 6 Pcs.

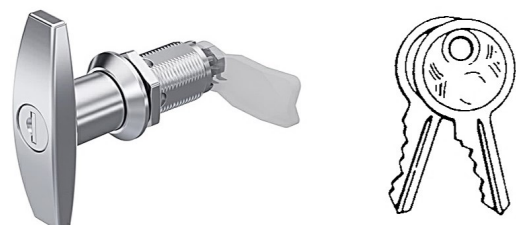

to get to a nut #8mm which is deeper, PIMEX has a special square spindle (839287) out of stainless steel 316/A4 #8x50/58mm with M6 at the end

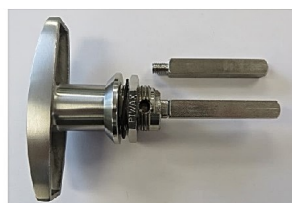

**PIMEX B.V.**  
Coenecoop 131  
2741 PJ WADDINXVEEN (NL)  
Tel. (31) 182 - 61 11 66  
Email: info@pimex.nl

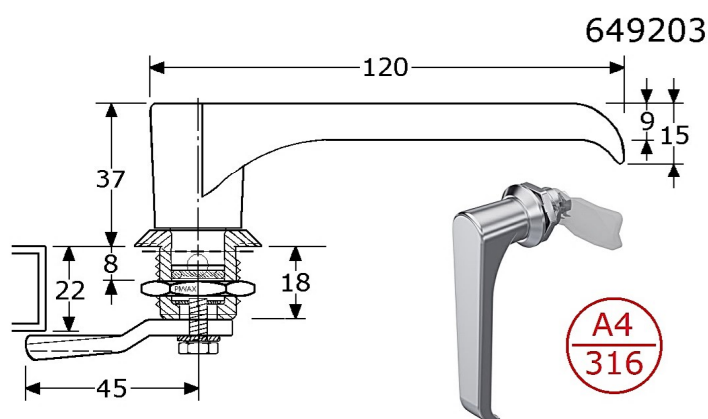

PIWAX "L"-handle length 120mm  
stainless steel 316/A4 satin polished  
body length 18mm, for maximum 8mm plate  
highness "L"-handle 37mm (without cylinder)  
with each 1 black packing/gasket  $\varnothing 28 \times 0,8$ mm  
with each 1 nut stainless steel 316/A4 M22  
backside: #8x8mm, for 90° action limited  
(cams have to be ordered separately)  
in boxes of 6 Pcs.

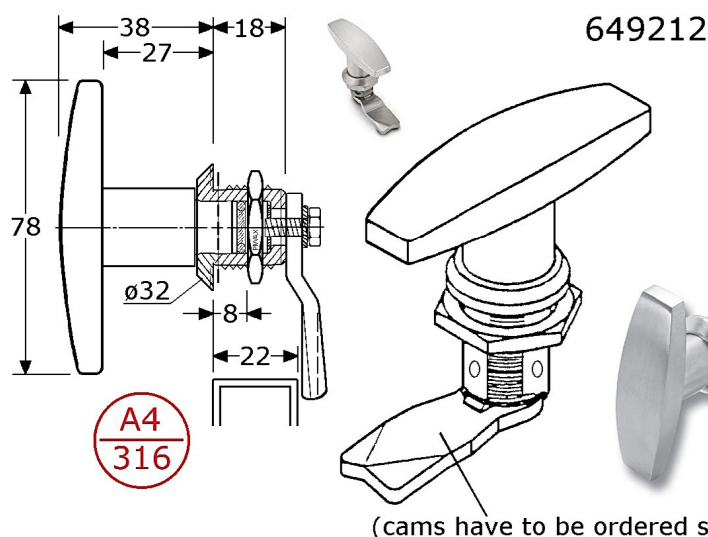
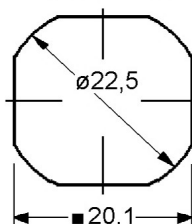

PIWAX "T"-handle 78mm  
stainless steel 316/A4 satin polished  
body length 18mm, for maximum 8mm plate  
highness "T"-handle 38mm (without cylinder)  
with each 1 black packing/gasket  $\varnothing 28 \times 0,8$ mm  
with each 1 nut stainless steel 316/A4 M22  
backside: #8x8mm, for 90° action limited  
(cams have to be ordered separately)  
in boxes of 6 Pcs.

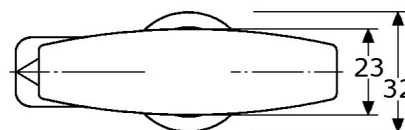

(cams have to be ordered separately)

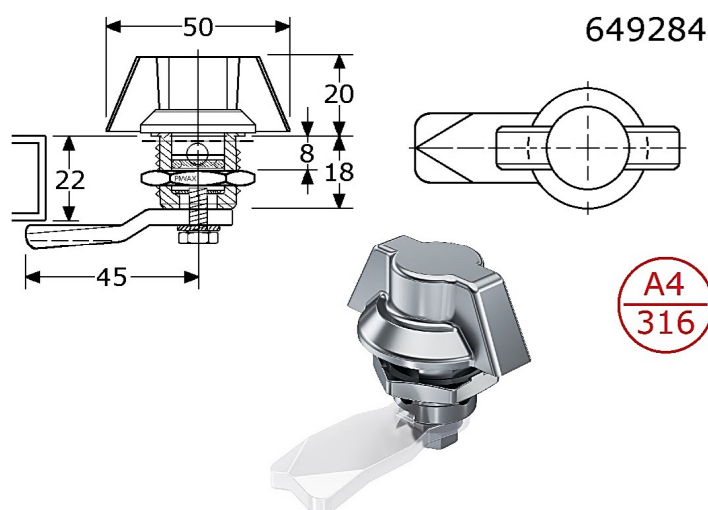

PIWAX wing handle 50mm  
stainless steel 316/A4 satin polished  
body length 18mm, for maximum 8mm plate  
highness wing handle only 20mm (without cylinder)  
with each 1 black packing/gasket  $\varnothing 28 \times 0,8$ mm  
with each 1 nut stainless steel 316/A4 M22  
backside: #8x8mm, for 90° action limited  
(cams have to be ordered separately)  
in boxes of 6 Pcs.

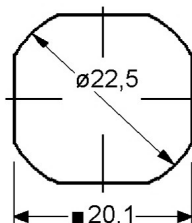

to get to a nut #8mm which is  
deeper, PIMEX has a special  
square spindle (839287)  
out of stainless steel 316/A4  
#8x50/58mm with M6 at  
the end



**PIMEX B.V.**  
Coenecoop 131  
2741 PJ WADDINXVEEN (NL)  
Tel. (31) 182 - 61 11 66  
Email: info@pimex.nl



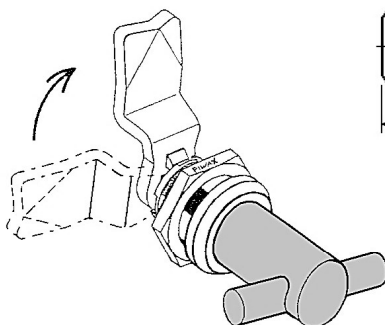
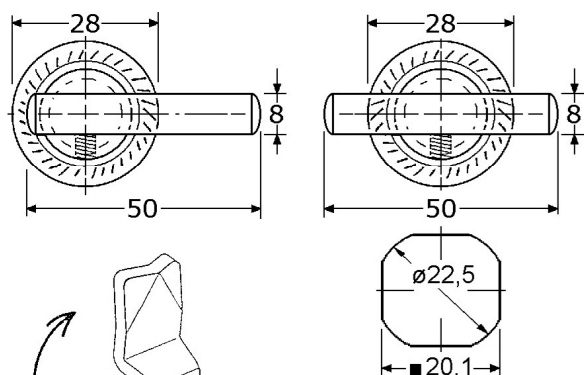

**A4  
316**

**650261**

complete stainless steel latches with knob/handle  
stainless steel 316/A4/1.4401  
with each inside 2 EPDM "O"-ring (better than IP65)  
sea-water continually, water and dust tight  
with each 1 black packing/gasket  $\varnothing 28 \times 0,8 \text{ mm}$   
with each 1 nut stainless steel 316/A4 M22  
\*\*\*

for LH and RH assembly and usable as down lock  
backside: #8x8mm, for 90° action limited  
hole pattern #20,1mm/ $\varnothing 22,5 \text{ mm}$   
mounting: a completely assembled latch can be  
pushed through the hole in the door

PIWAX latch L=18mm with T-handle  $\varnothing 8 \times 50 \text{ mm}$   
stainless steel 316/A4/1.4401  
sea-water continually, with double "O"-ring  
short type, body length 18mm  
inside part out of 1 short piece (no loose adapters !!)  
for use door thickness 1-11mm  
backside: #8x8mm (cams to be ordered separately)  
in boxes of 12 Pcs.

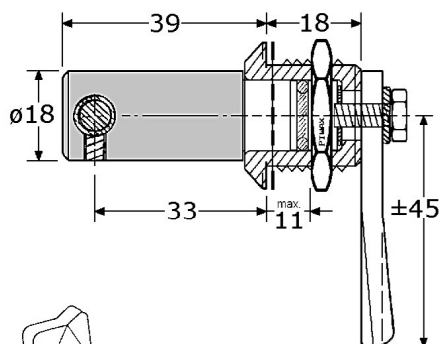

**650262**

PIWAX latch L=18mm with handle  $\varnothing 8 \times 125 \text{ mm}$   
stainless steel 316/A4/1.4401  
sea-water continually, with double "O"-ring  
short type, body length 18mm  
inside part out of 1 short piece (no loose adapters !!)  
for use door thickness 1-11mm  
backside: #8x8mm (cams to be ordered separately)  
in boxes of 12 Pcs.

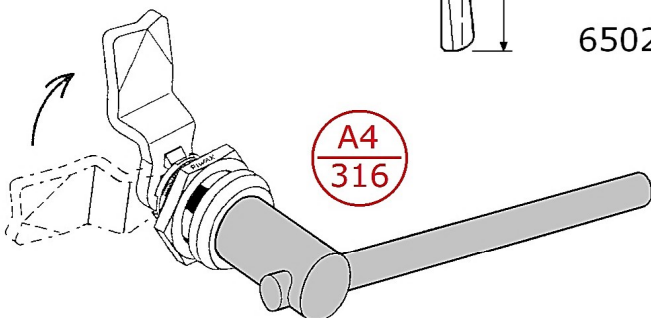

**A4  
316**

**650263**

PIWAX latch L=18mm with handle  $\varnothing 8 \times 145 \text{ mm}$   
stainless steel 316/A4/1.4401  
sea-water continually, with double "O"-ring  
short type, body length 18mm  
inside part out of 1 short piece (no loose adapters !!)  
for use door thickness 1-11mm  
backside: #8x8mm (cams to be ordered separately)  
in boxes of 12 Pcs.

different cams (thickness 4mm) for  
different situations:

**650279**

PIWAX cam stainless steel 316 -12mm ( $18-12=6$ )

**650280**

PIWAX cam stainless steel 316 0mm ( $18+0=18$ )

**650281**

PIWAX cam stainless steel 316 +4mm ( $18+4=22$ )

**650282**

PIWAX cam stainless steel 316 +10mm ( $18+10=28$ )

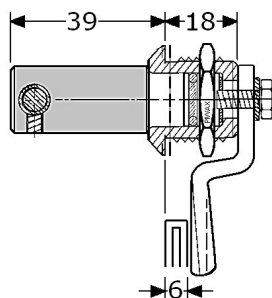

65026. +650279

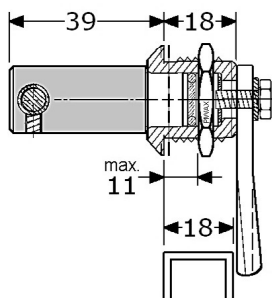

65026. +650280

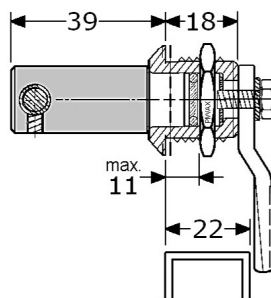

65026. +650281

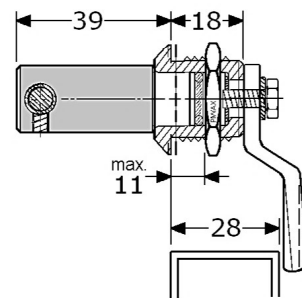

65026. +650282

**A4  
316**

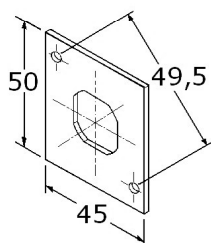

in stock we have  
mounting plates in  
stainless steel 316/A4  
with 2 holes  $\varnothing 4 \text{ mm}$  (650293)  
or without holes (650295),  
see page GY-651a



**PIMEX B.V.**  
Coenecoop 131  
2741 PJ WADDINXVEEN (NL)  
Tel. (31) 182 - 61 11 66  
Email: info@pimex.nl

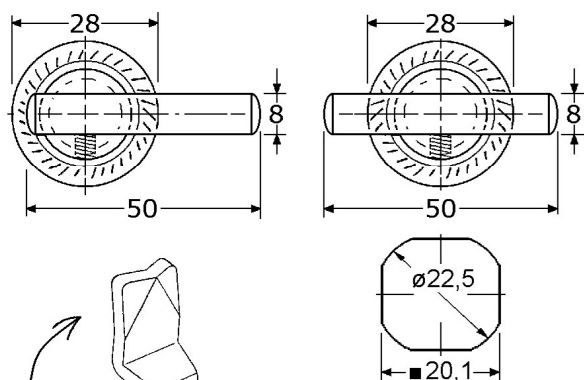

**A4**  
**316**

complete stainless steel latches with knob/handle  
stainless steel 316/A4/1.4401  
with each inside 2 EPDM "O"-ring (better than IP65)  
sea-water continually, water and dust tight  
with each 1 black packing/gasket  $\varnothing 28 \times 0,8$ mm  
with each 1 nut stainless steel 316/A4 M22  
\*\*\*

for LH and RH assembly and usable as down lock  
backside: #8x8mm (cams to be ordered separately)  
hole pattern #20,1mm/ $\varnothing 22,5$ mm  
mounting: cams assembling after pushing the  
latch through the hole in the door

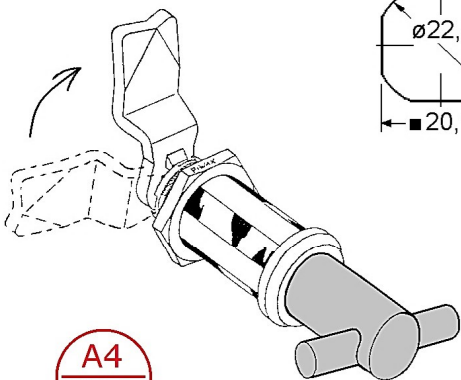

**A4**  
**316**

**650271**

PIWAX latch L=50mm with T-handle  $\varnothing 8 \times 50$ mm  
stainless steel 316/A4/1.4401  
sea-water continually, with double "O"-ring  
long type, body length 50mm  
inside part out of 1 long piece (no loose adapters !!)  
for use door thickness 1-42mm  
backside: #8x8mm (cams to be ordered separately)  
in boxes of 12 Pcs.

**650272**

PIWAX latch L=50mm with handle  $\varnothing 8 \times 125$ mm  
stainless steel 316/A4/1.4401  
sea-water continually, with double "O"-ring  
long type, body length 50mm  
inside part out of 1 long piece (no loose adapters !!)  
for use door thickness 1-42mm  
backside: #8x8mm (cams to be ordered separately)  
in boxes of 12 Pcs.

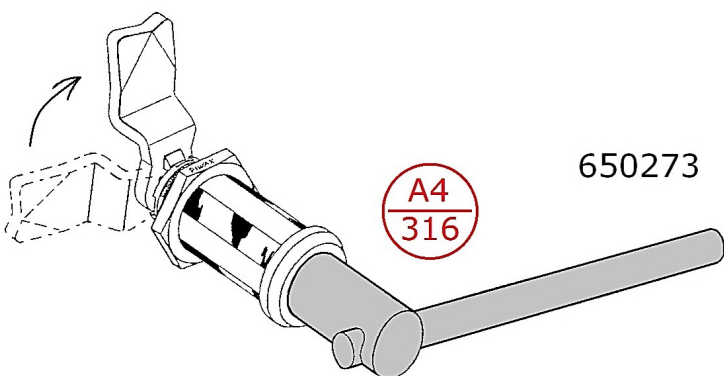

**A4**  
**316**

**650273**

PIWAX latch L=50mm with handle  $\varnothing 8 \times 145$ mm  
stainless steel 316/A4/1.4401  
sea-water continually, with double "O"-ring  
long type, body length 50mm  
inside part out of 1 long piece (no loose adapters !!)  
for use door thickness 1-42mm  
backside: #8x8mm (cams to be ordered separately)  
in boxes of 12 Pcs.

different cams (thickness 4mm) for  
different situations:

**650279**

PIWAX cam stainless steel 316 -12mm (50-12=38)

**650280**

PIWAX cam stainless steel 316 0mm (50+0=50)

**650281**

PIWAX cam stainless steel 316 +4mm (50+4=54)

**650282**

PIWAX cam stainless steel 316 +10mm (50+10=60)

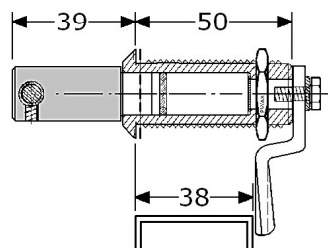

65027. +650279

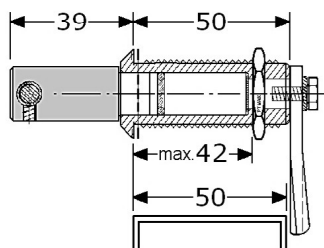

65027. +650280

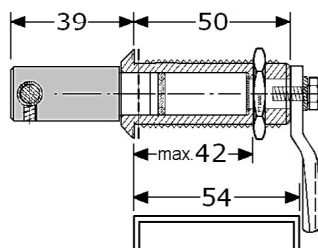

65027. +650281

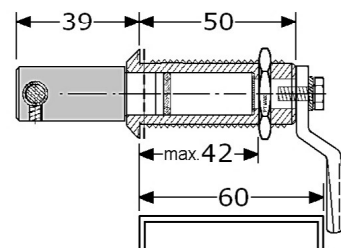

65027. +650282

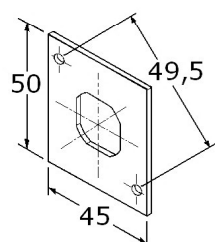

in stock we have  
mounting plates in  
stainless steel 316/A4  
with 2 holes  $\varnothing 4$ mm (650293)  
or without holes (650295),  
see page GY-651a

**A4**  
**316**



**PIMEX B.V.**  
Coenecoop 131  
2741 PJ WADDINXVEEN (NL)  
Tel. (31) 182 - 61 11 66  
Email: info@pimex.nl