

WELD-ON HINGES, stainless steel

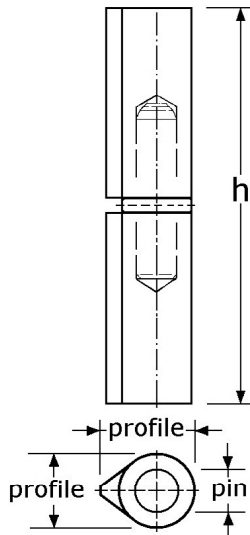
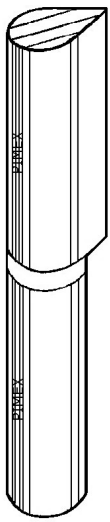

weld-on hinges
 stainless steel 304/A2/1.4301
 profile with welding point, top flat head
 for left and right use
 with fixed (in under part) pin stainless steel 303/1.4305
 with massive washer stainless steel 303/1.4305

348200
 348201
 348203

high	profile	fixed pin	in boxes of
45mm	12x10mm	ø 6mm	20 Pcs
60mm	12x10mm	ø 6mm	20 Pcs
80mm	16x13mm	ø 8mm	20 Pcs

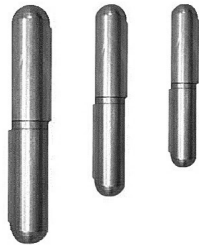
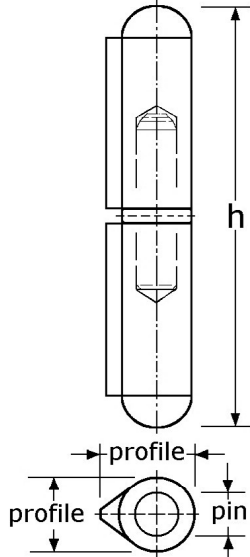
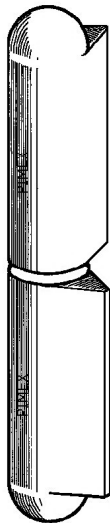

weld-on hinges
 stainless steel 304/A2/1.4301
 profile with welding point, top rounded head
 for left and right use
 with fixed (in under part) pin stainless steel 303/1.4305
 with massive washer stainless steel 303/1.4305

348230
 348231
 348232
 348234
 348235
 348236
 348237
 348238
 348239

high	profile	fixed pin	in boxes of
50mm	10x8 mm	ø 5mm (narrow profile)	25 Pcs
60mm	12x10mm	ø 6mm	20 Pcs
80mm	16x13mm	ø 8mm	20 Pcs
100mm	20x16mm	ø10mm	20 Pcs
120mm	20x16mm	ø11mm	20 Pcs
135mm	23x18mm	ø12,5mm	10 Pcs
150mm	25x20mm	ø13mm	10 Pcs
180mm	25x20mm	ø13mm	10 Pcs
200mm	28x23mm	ø16mm	10 Pcs

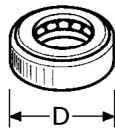
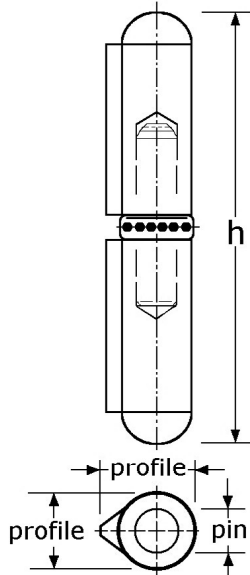

weld-on hinges
 stainless steel 304/A2/1.4301
 profile with welding point, top rounded head
 for left and right use
 with fixed (in under part) pin stainless steel 303/1.4305
 with ball bearing stainless steel 304/1.4301
 (outside & inside SS-304/A2, balls SS-420 hardened)

348434
 348437
 348438
 348439

high	profile	fixed pin	D	in boxes of
104mm	20x16mm	ø10mm	ø17,5mm	20 Pcs
155mm	25x20mm	ø13mm	ø22mm	10 Pcs
185mm	25x20mm	ø13mm	ø22mm	10 Pcs
206mm	28x23mm	ø16mm	ø27mm	10 Pcs

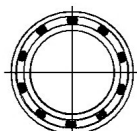

PIMEX B.V.
 Coenecoop 131
 2741 PJ WADDINXVEEN (NL)
 Tel. (31) 182 - 61 11 66
 Email: info@pimex.nl

WELD-ON HINGES, stainless steel

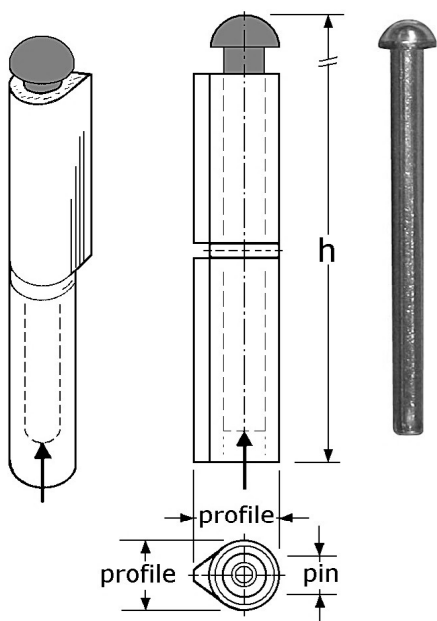

348242
348244

weld-on hinges
stainless steel 304/A2/1.4301
profile with welding point, top rounded
with loose removable pin stainless steel 303/1.4305
can be very handy, but low safety ###
with massive washer stainless steel 303/1.4305

high	profile	loose pin	in boxes of
80mm	16x13mm	∅ 8mm	20 Pcs
100mm	20x16mm	∅11mm (40+46mm)	20 Pcs

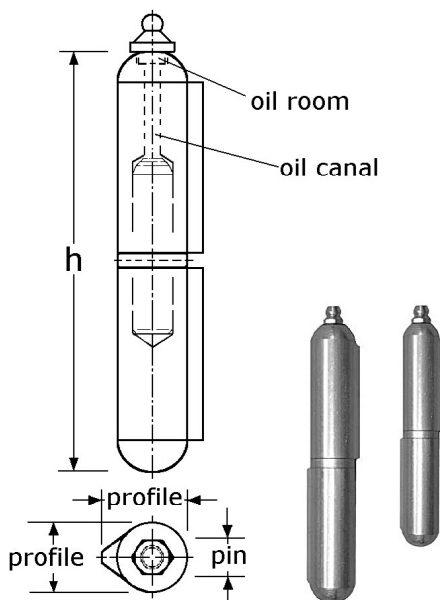

348262
348264
348265
348266
348267
348268
348269

weld-on hinges
stainless steel 304/A2/1.4301
profile with welding point, top rounded head
with stainless steel (screwed) grease/lubricating nipple
with oil room & oil canal
with fixed (in under part) pin stainless steel 303/1.4305
with massive washer stainless steel 303/1.4305

high	profile	fixed pin	in boxes of
80mm	16x13mm	∅ 8mm	20 Pcs
100mm	20x16mm	∅10mm	20 Pcs
120mm	20x16mm	∅11mm	20 Pcs
135mm	23x18mm	∅12,5mm	10 Pcs
150mm	25x20mm	∅13mm	10 Pcs
180mm	25x20mm	∅13mm	10 Pcs
200mm	28x23mm	∅16mm	10 Pcs

for H=60mm with grease nipple, see 349251 (GY-349b)

for weld-on hinges in stainless steel 316/A4,
see page GY-349a & GY-349b

for heavy duty hinges M12, M16 and M20
in stainless steel 316/A4,
see page GY-398b & GY-398c

for combination of weld-on hinges
in stainless steel with flaps,
see page GY-345b & GY-346b

for weld-on hinges in steel (also in stock),
see page GF-449a & GF-449b (group 04)

for weld-on hinges in aluminium (stock),
see page GF-450 (group 04)

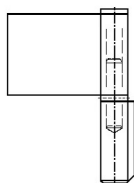

PIMEX B.V.
Coenecoop 131
2741 PJ WADDINXVEEN (NL)
Tel. (31) 182 - 61 11 66
Email: info@pimex.nl

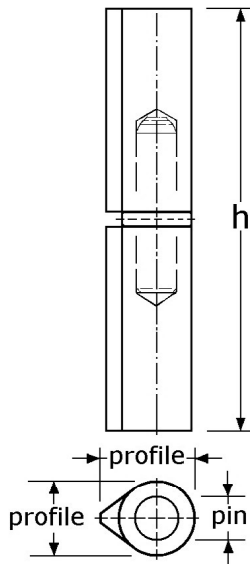
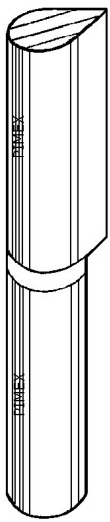

A4
316

PIROSTA weld-on hinges
stainless steel 316/A4/1.4401
acid and seawater continually
profile with welding point, top flat head
for left and right use
with fixed (in under part) pin stainless steel 316/1.4404
with massive washer stainless steel 316/1.4404

349209
349210
349211
349212
349214
349215

high	profile	fixed pin	in boxes of
45mm	10x8 mm	ø 5mm (narrow profile)	25 Pcs
45mm	12x10mm	ø 6mm	20 Pcs
60mm	12x10mm	ø 6mm	20 Pcs
80mm	16x13mm	ø 8mm	20 Pcs
100mm	20x16mm	ø10mm	20 Pcs
120mm	20x16mm	ø11mm	20 Pcs

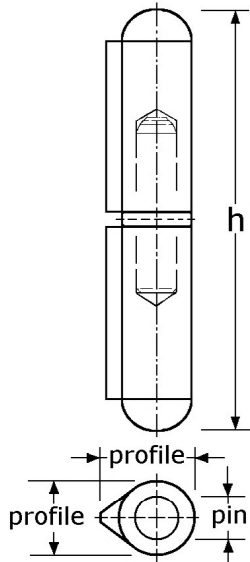
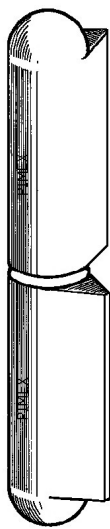

A4
316



PIROSTA weld-on hinges
stainless steel 316/A4/1.4401
acid and seawater continually
profile with welding point, top rounded head
for left and right use
with fixed (in under part) pin stainless steel 316/1.4404
with massive washer stainless steel 316/1.4404

349274

high	profile	fixed pin	in boxes of
100mm	20x16mm	ø10mm	20 Pcs

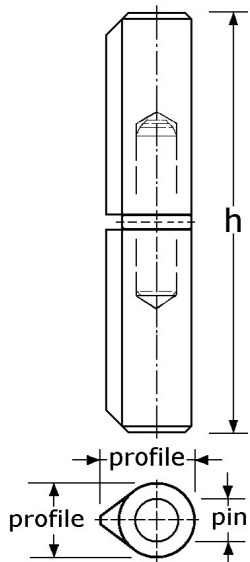
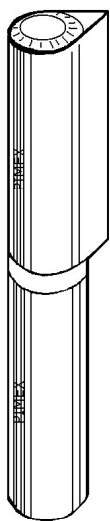

A4
316

PIROSTA weld-on hinges
stainless steel 316/A4/1.4401
acid and seawater continually
profile with welding point, top flat head (smooth border)
for left and right use
with fixed (in under part) pin stainless steel 316/1.4404
with massive washer stainless steel 316/1.4404

349227
349228
349229

high	profile	fixed pin	in boxes of
150mm	25x20mm	ø13mm	10 Pcs
180mm	25x20mm	ø13mm (on request)	500 Pcs
200mm	28x23mm	ø16mm (on request)	500 Pcs



PIMEX B.V.
Coenecoop 131
2741 PJ WADDINXVEEN (NL)
Tel. (31) 182 - 61 11 66
Email: info@pimex.nl

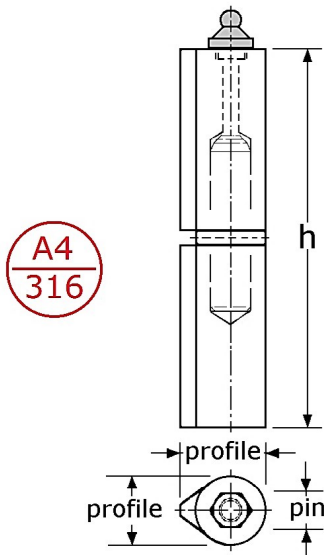

A4
316

A4
316

PIROSTA weld-on hinges
stainless steel 316/A4/1.4401
acid and seawater continually
profile with welding point, top flat head
with stainless steel 316/1.4401 grease/lubricating nipple
with oil room & oil canal (nipple screwed)
with fixed (in under part) pin stainless steel 316/1.4404
with massive washer stainless steel 316/1.4404

349251
349252
349254
349255

high	profile	fixed pin	in boxes of
60mm	12x10mm	∅ 6mm	20 Pcs
80mm	16x13mm	∅ 8mm	20 Pcs
100mm	20x16mm	∅10mm	20 Pcs
120mm	20x16mm	∅11mm	20 Pcs

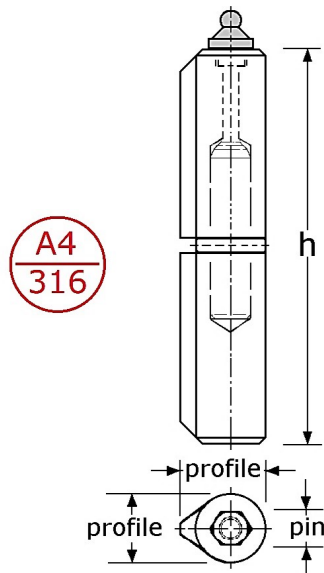

A4
316

A4
316

PIROSTA weld-on hinges
stainless steel 316/A4/1.4401
acid and seawater continually
profile with welding point, top flat head (smooth border)
with stainless steel 316/1.4401 grease/lubricating nipple
with oil room & oil canal (nipple screwed)
with fixed (in under part) pin stainless steel 316/1.4404
with massive washer stainless steel 316/1.4404

349257
349258
349259

high	profile	fixed pin	in boxes of
150mm	25x20mm	∅13mm	10 Pcs
180mm	25x20mm	∅13mm (on request)	500 Pcs
200mm	28x23mm	∅16mm (on request)	500 Pcs

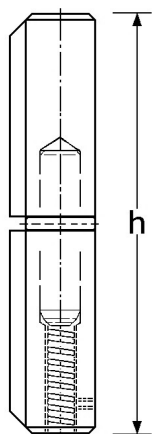

A4
316

A4
316



PIROSTA weld-on hinges
stainless steel 316/A4/1.4401
profile with welding point, top flat head (smooth border)
with high adjustment (by hexagon socket set screw M8)
(screw M8 can be fixed by hexagon socket set screw M4)
with fixed (in upper part) pin stainless steel 316/1.4404
(pin can also in under part, but then you will see
always the hexagon socket set screw in top)
with massive washer stainless steel 316/1.4404

349384

high	profile	fixed pin	in boxes of
100mm	20x16mm	∅10mm	20 Pcs

for adjustable weld-on hinges
with grease/lubricating nipple
in stainless steel 316/A4,
see page GY-398b
and page GY-398c

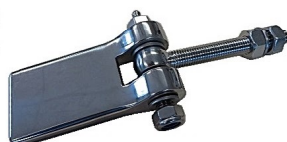

PIMEX B.V.
Coenecoop 131
2741 PJ WADDINXVEEN (NL)
Tel. (31) 182 - 61 11 66
Email: info@pimex.nl

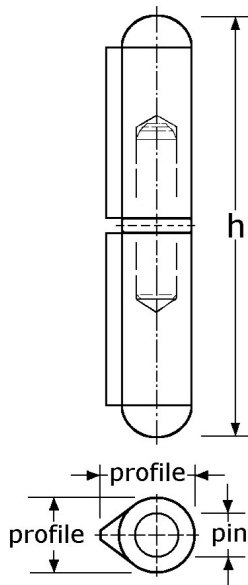
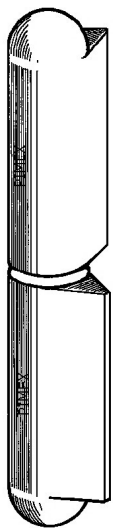

456511
456512
456514
456515
456517
456518

weld-on hinges
aluminium (AlMg Si 0,5)
profile with welding point, top rounded head
with fixed (in under part) pin stainless steel 303/1.4305
with massive washer stainless steel 303/1.4305

high	profile	fixed pin	in boxes of
60mm	12x10mm	∅ 6mm	20 Pcs
80mm	16x13mm	∅ 8mm	20 Pcs
100mm	20x16mm	∅10mm	20 Pcs
120mm	20x16mm	∅11mm	20 Pcs
150mm	25x20mm	∅13mm	10 Pcs
180mm	25x20mm	∅14mm	10 Pcs

for weld-on hinges in stainless steel, see page GY-348a
for weld-on hinges in steel, see page GF-449a
also possible: combination aluminium + stainless steel

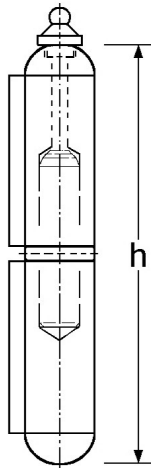
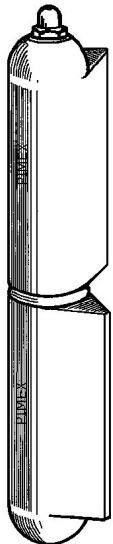

456562
456564
456565
456567

weld-on hinges
aluminium (AlMg Si 0,5)
profile with welding point, top rounded head
with stainless steel (screwed) grease/lubricating nipple
with oil room & oil canal
with fixed (in under part) pin stainless steel 303/1.4305
with massive washer stainless steel 303/1.4305

high	profile	fixed pin	in boxes of
80mm	16x13mm	∅ 8mm	20 Pcs
100mm	20x16mm	∅10mm	20 Pcs
120mm	20x16mm	∅11mm	100 Pcs
150mm	25x20mm	∅13mm	10 Pcs

for weld-on hinges in stainless steel, see page GY-348b
for weld-on hinges in steel, see page GF-449b

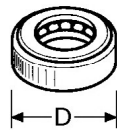
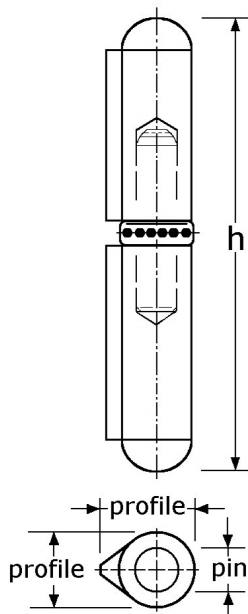
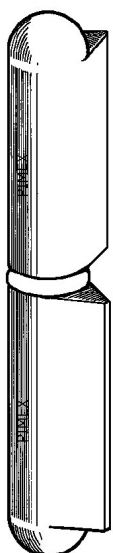

456584
456587

weld-on hinges
aluminium (AlMg Si 0,5)
profile with welding point, top rounded head
for left and right use
with fixed (in under part) pin stainless steel 303/1.4305
with ball bearing stainless steel 304/1.4301
(outside & inside SS-304/A2, balls SS-420 hardened)

high	profile	fixed pin	D	in boxes of
104mm	20x16mm	∅10mm	∅17,5mm	20 Pcs
155mm	25x20mm	∅13mm	∅22mm	10 Pcs

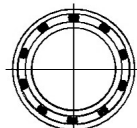

PIMEX B.V.
Coenecoop 131
2741 PJ WADDINXVEEN (NL)
Tel. (31) 182 - 61 11 66
Email: info@pimex.nl